

ManualsLib.com

Parts identification

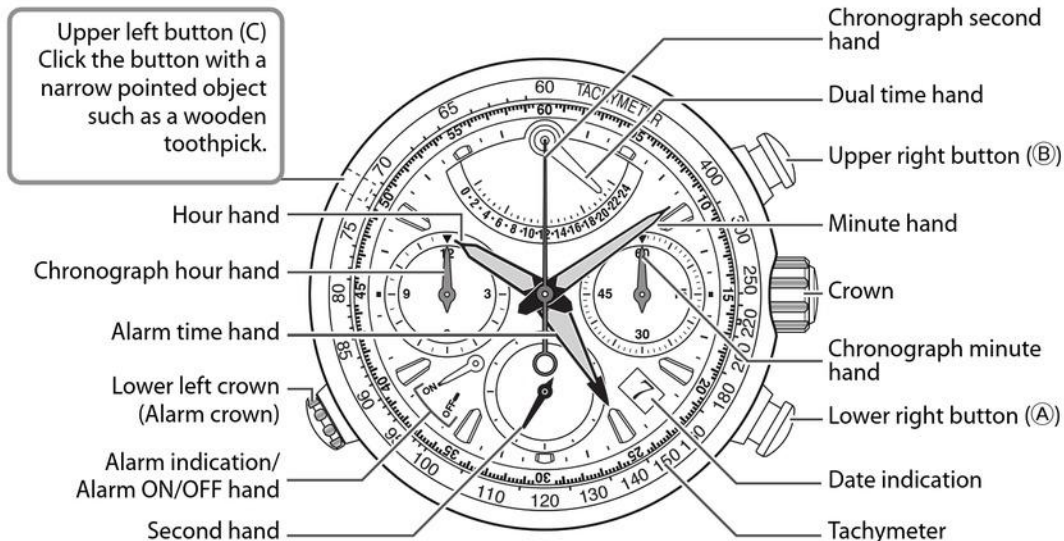

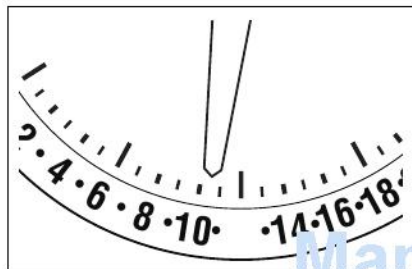

- The illustrations in this instruction manual may differ from the actual appearance of your watch.

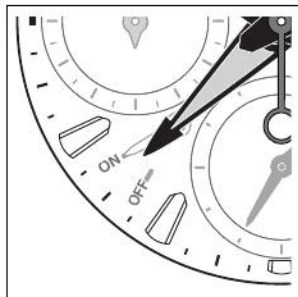

ManualsLib.com



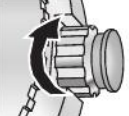

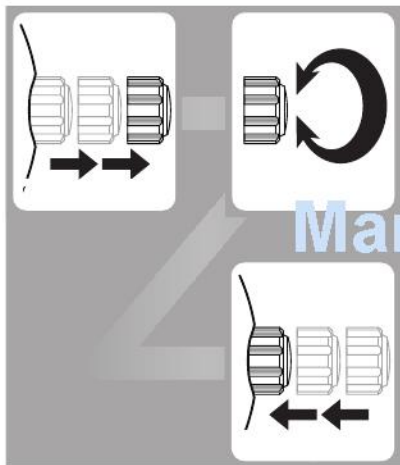
ManualsLib.com



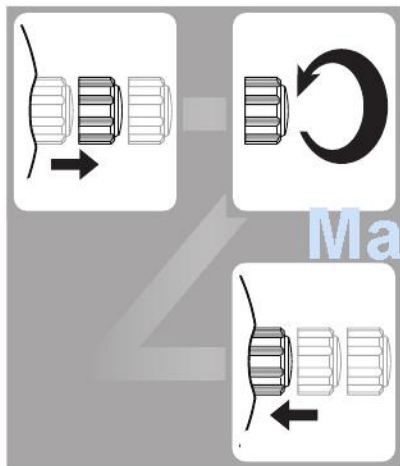

ManualsLib.com



Using the chronograph

You can record up to 12 hours in increments of 0.2 seconds.

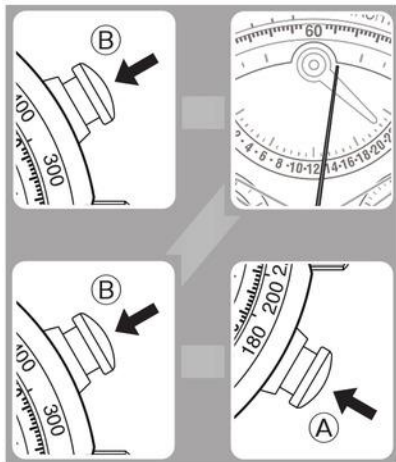

- 1. Ensure that the crown is in position 0.**
- 2. Press the upper right button (B) to start timing.**
 - The button clicks only when timing is activated.
 - The chronograph operates no matter the position of the crown.
 - The chronograph stops automatically 12 hours later.
- 3. Press the upper right button (B) to stop timing.**
 - Pressing the upper right button (B) again restarts timing from the point of the previously recorded time.

To reset the chronograph

Press the lower right button (A) after stopping the chronograph by pressing the upper right button (B).

- You must reset the chronograph after timing for using other functions.

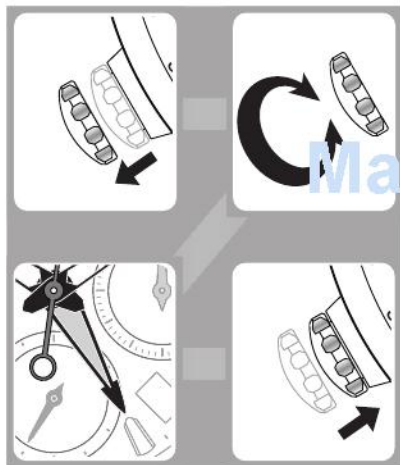

ManualsLib.com

ManualsLib.com

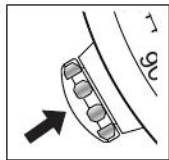



ManualsLib.com

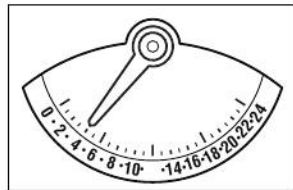
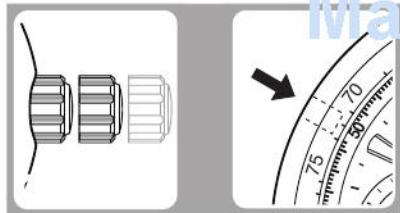

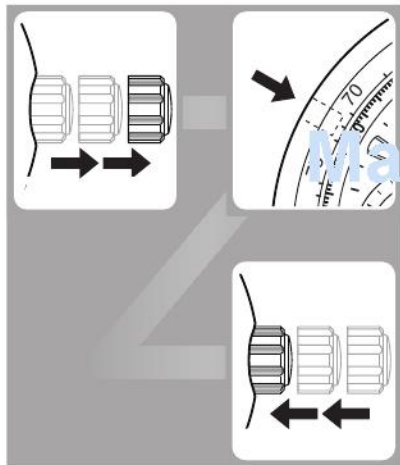

ManualsLib.com

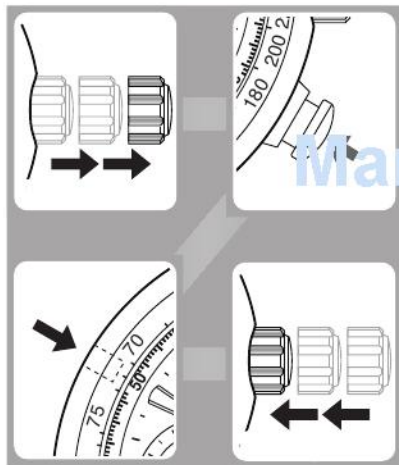

ManualsLib.com

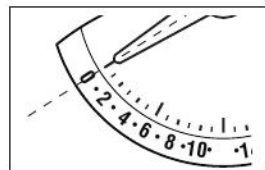

Using the tachymeter

The tachymeter easily brings you the average speed by recording a lap time to go one kilometer.

- You can measure the approximate average speed from 60 km/h up to 400 km/h.
- The illustrations in this manual may differ from the actual appearance of your watch.
- Some models do not feature the tachymeter.

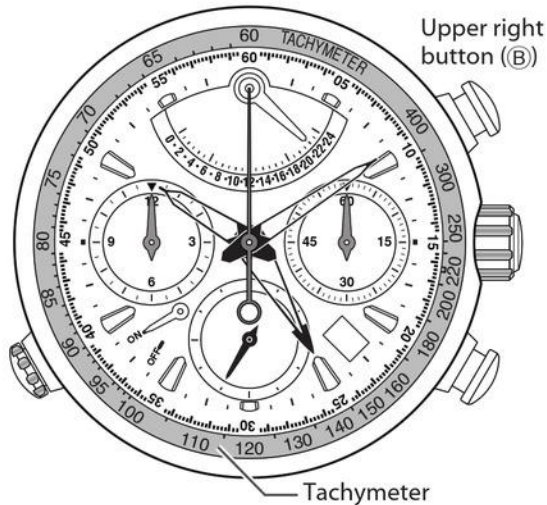

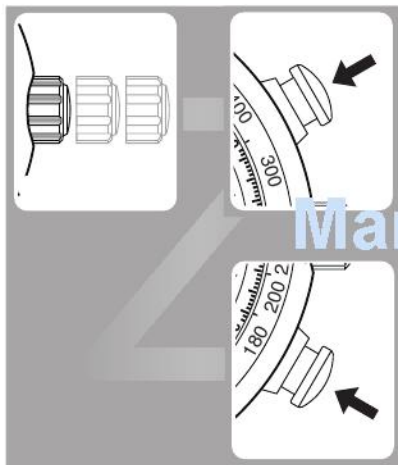

ManualsLib.com



ManualsLib.com

ManualsLib.com



I

	ManualsLib.com		

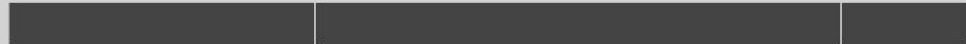

ManualsLib.com	ManualsLib.com	

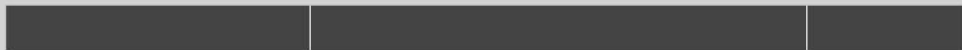

ManualsLib.com

I

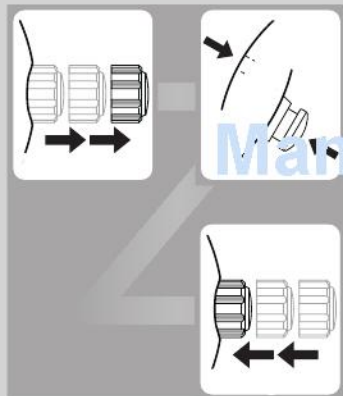

ManualsLib.com

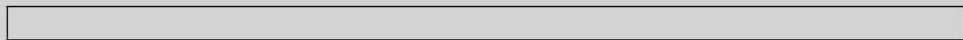



ManualsLib.com

ManualsLib.com



ManualsLib.com

ManualsLib.com

ManualsLib.com

ManualsLib.com



ManualsLib.com

ManualsLib.com

A thick black L-shaped line is positioned at the top left of the page. A vertical black bar is located on the left side, below the L-shaped line. Another vertical black bar is located on the left side, below the text.

ManualsLib.com



ManualsLib.com

	ManualsLib.com		



ManualsLib.com