

**ManualsLib.com**

**ManualsLib.com**

### 3. Names of Components

Name/Mode	Time/Calendar	Chronograph
① Mode hand	TME	CHR
② Function hand	Stops at 0-position	Chronograph minutes, 1/20th seconds
③ Date	Displays date	Date display (TME or L-TM)
④ Hour hand	Displays hours	Displays hours (TME, L-TM or ALM)
⑤ Minute hand	Displays minutes	Displays minutes (TME, L-TM or ALM)
⑥ Second hand	Displays seconds	Chronograph seconds
⑦ 24 hour hand	24-hour time display in coordination with hour hand	24-hour time display in coordination with hour hand

Local Time	Alarm
L-TM	ALM
Stops at 0-position	Stops at 0-position
Displays date of local time	Date display (TME or L-TM)
Displays hours of local time	Displays alarm hours
Displays minutes of local time	Displays alarm minutes
Displays seconds	Displays ON/OFF
24-hour local time display in coordination with hour hand	24-hour alarm time display in coordination with hour hand

Name	Crown position	Time/Calendar	Chronograph
⑧ Crown	Normal position	Mode switching	Mode switching
	Position 1	Calendar correction	0-position check/correction (function hand, date wheel)
	Position 2	Time correction	0-position check/correction (second hand, 24 hour hand, hour hand, minute hand)
Button (A)	Normal position	Not used	Start/stop, reset (pressing continuously for at least 2 seconds)
	Position 1	Year correction	Function hand and date wheel 0-position correction
	Position 2	Not used	Second hand 0-position correction
Button (B)	Normal position	Not used	Recalls 1/20 seconds when stopped
	Position 1	Month correction	Not used
	Position 2	Not used	Not used

Local Time	Alarm
Mode switching	Mode switching
Local time display	Alarm ON/OFF setting
Local time correction	Alarm time correction (including ON/OFF switching)
Not used	Alarm tone monitor (pressing continuously for at least 2 seconds)
Not used	ON/OFF switching
Not used	ON/OFF switching
Not used	Not used
Not used	Not used
Not used	Not used

ManualsLib.com

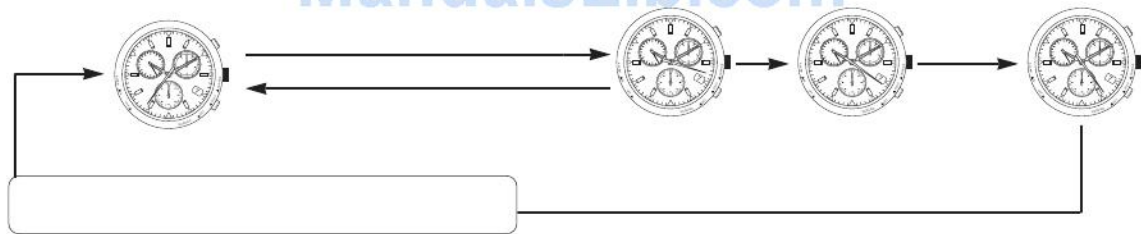

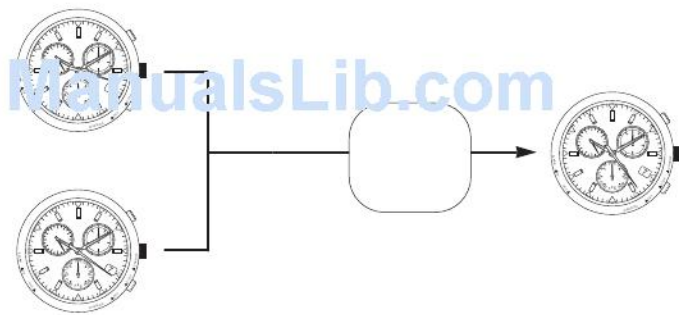

ManualsLib.com



[ManualsLib.com](http://ManualsLib.com)





ManualsLib.com

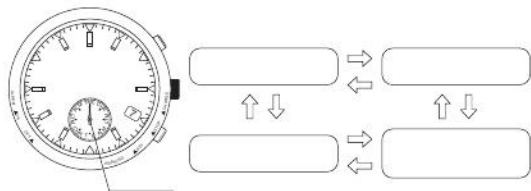

ManualsLib.com

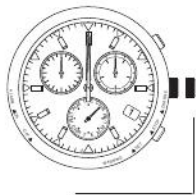

**ManualsLib.com**

[ManualsLib.com](http://ManualsLib.com)

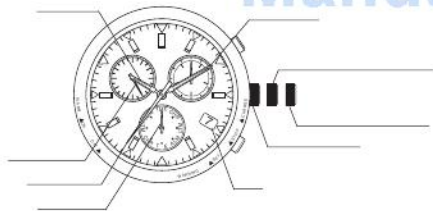

ManualsLib.com

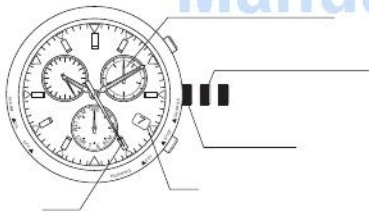

4. Pressing button (A) allows correction of the year (number of years elapsed since the most recent leap year). Press button (A) and align the function hand at the position corresponding to the year (number of years elapsed since the most recent leap year).

**\* Interpretation of Year/Position of Function Hand \***

Leap year : 0 minutes position  
 1 year after most recent leap year : 6 minutes position  
 2 years after most recent leap year : 12 minutes position  
 3 years after most recent leap year : 18 minutes position

**Quick Reference Table for No. of Years Since Most Recent Leap Year:**

Year	Years elapsed	Year	Elapsed years
2000	Leap year	2004	Leap year
2001	1st year	2005	1st year
2002	2nd year	2006	2nd year
2003	3rd year	2007	3rd year

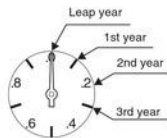

5. Pressing button (B) allows correction of the month. Press button (B) and align the second hand at the position corresponding to the month.

**\* Interpretation of Month/ Position of Second Hand\***

January: 1:00 position  
 February: 2:00 position  
 March: 3:00 position  
 :  
 December: 12:00 position

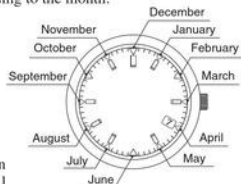

6. Return the crown to the normal position after setting the date. The watch will resume keeping time once the second hand catches up to the current seconds.

**<When the Calendar has been Set to a Non-existent Date>**

When the crown is returned to the normal position from the date correction mode, the watch switches to the 1st day of the following month.  
 Example: February 29, 30 or 31 in an ordinary year → March 1  
 February 30 or 31 in a leap year → March 1

ManualsLib.com



ManualsLib.com

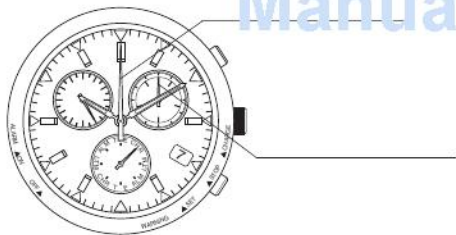

ManualsLib.com



ManualsLib.com



**ManualsLib.com**

ManualsLib.com

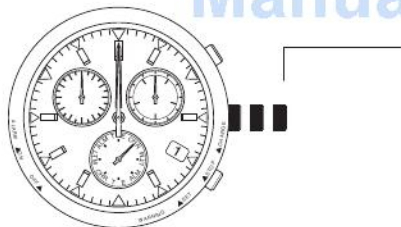

MantalsLib.com



**ManualsLib.com**

**ManualsLib.com**

**ManualsLib.com**