

SEIKO WATCH CORPORATION

SEIKO
GS
Grand Seiko

SEIKO WATCH CORPORATION

SEIKO

GS

Grand Seiko





all-guides.com













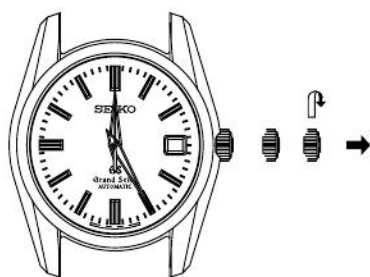

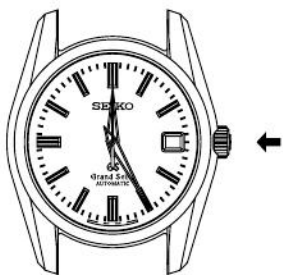



3. 3 HANDS WITH 24-HOUR HAND (cal. 9S56)

<Parts of your Grand Seiko watch>



12

This watch, Cal.9S56, features a time difference adjustment function.

Two different time zones can be displayed at the same time when you set the hour hand and 24-hour hand respectively in accordance with each time zone.

※The hour hand and the date may not indicate the desired time and date. It is not necessary to adjust them at this step as they can be adjusted independently later. (→Refer to P.13 and P.20~21)

※To set the time accurately, first turn the minute hand about 5 minutes behind the desired time and then advance it slowly to the correct time.

<To set the 24-hour hand to the current time of your area>

- ① Pull out the crown to the second click when the second hand is at the 12 o'clock position. The second hand stops on the spot.
- ② Turn the crown clockwise to set the 24-hour and minute hands to the current time of your area. Check that AM/PM is correctly set.



<Example>

To set 10:00 AM,
set the 24-hour hand to the 5 o'clock position and the minute hand to the 12 o'clock position.

To set 6:00 PM,
set the 24-hour hand to the 9 o'clock position and the minute hand to the 12 o'clock position.

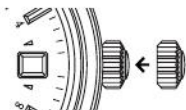
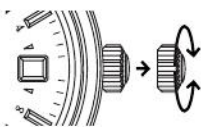
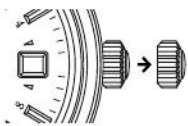
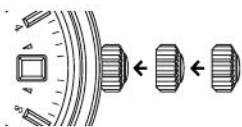

<To set the 24-hour hand to the time of an area in a different time zone>

For example, set the 24-hour hand to Greenwich Mean Time and the hour hand to the current time of Japan

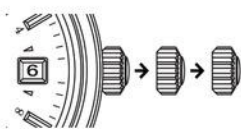

- ① Pull out the crown to the second click when the second hand is at the 12 o'clock. The second hand stops on the spot.
- ② Turn the crown clockwise to set the 24-hour and minute hands to the Greenwich Mean Time. Check that AM/PM is correctly set.

<Example>

- 14 When it is 10:00 AM in Japan, the time difference between Greenwich Mean Time and the time in Japan is -9 hours, so it is 1:00 AM on Greenwich Mean Time. Therefore, set the 24-hour hand to the middle point between the 12 o'clock and 1 o'clock position, and the minute hand to the 12 o'clock position.



※To set the time accurately, first turn the minute hand about 5 minutes behind the desired time and then advance it slowly to the correct time.

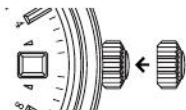
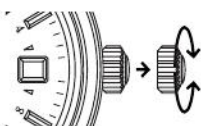
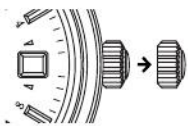
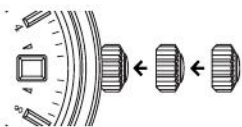



■ Time difference adjustment

- Set the hour hand to the time of any area using the time difference obtained in "How to calculate the time differences"

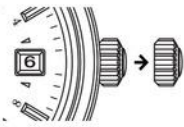

① Pull out the crown to the first click.

② Turn the crown to set the hour hand to the time of any area.

※When setting the hour hand, other hands may move slightly. However, this is not a malfunction.

※If you need to set the date between 10 PM and 0 AM by turning the hour hand counterclockwise, turn the hour hand until it shows sometime between 9 PM and 10 PM once, then set the date. In case the hour hand is turned counterclockwise, the date will be moved back when the hour hand shows around 10 PM, however, it is not a malfunction.



clockwise :
the hour hand
turns clockwise

counterclockwise :
the hour hand
turns counterclockwise

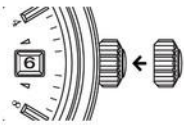

③ After setting the hour hand, push back the crown into the normal position.

all-guides.com

<To set the date>

20



The date can be changed by turning the hour hand one or two full circles, using it as "time difference adjustment".

clockwise :

The hour hand turns clockwise, and the date advances.

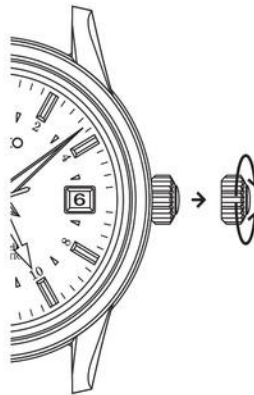

- 1 Pull out the crown to the first click.
- 2 Turn the crown to set the date. By turning the hour hand at the maximum two full circles clockwise or counterclockwise, one day is advanced or put back, respectively.

counterclockwise :

The hour hand turns counterclockwise, and the date is put back.









A large rectangular frame with a thin black border. A horizontal line is drawn near the top of the frame, starting from the left edge and extending about halfway across. A vertical line is drawn on the left side of the frame, extending from the top edge down to the bottom edge. A horizontal line also extends from the right side of the top box into the frame, connecting to the top edge.



A large, empty rectangular frame, likely intended for a diagram or detailed notes. It is connected to the warning icon box by a horizontal line.









