

Thank you for your purchase of this Citizen watch.

Before using the watch, read this instruction manual carefully to ensure correct use. After reading the manual, store it in a safe place for future reference.

Be sure to visit the Citizen website at <https://www.citizenwatch-global.com/>. Some models may be equipped with enhanced features functions such as slide rules and tachymeters. You can also see how to use such features and functions, which is not covered with the instruction manual, in the web site.

To check the movement number

A case number—4 alphanumeric characters and 6 or more alphanumeric characters—is engraved on the case back.

The first 4 characters of the case number represent the movement number of the watch.

In the example, “△△△△” is the movement number.

Engraving position example

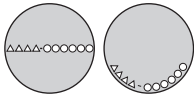

The engraving position may differ depending on watch model.

Safety precautions — IMPORTANT

This manual contains instructions that should be strictly followed at all times not only for optimal use, but to prevent any injuries to yourself, other persons or property. We encourage you to read the entire booklet (especially, pages 11 and 12) and understand the meaning of the following symbols:

■ Safety advisories are categorized and depicted in this manual as follows:

	DANGER	Highly likely to cause death or serious injury
	WARNING	Can cause serious injury or death
	CAUTION	Can or will cause minor or moderate injury or damage

■ Important instructions are categorized and depicted in this manual as follows: (Following symbols are examples of Pictograms.)

	Warning (caution) symbol followed by prohibited matters.
	Warning (caution) symbol followed by instructions that should be followed or precautions that should be observed.

Features



■ **Connection with a smartphone through the dedicated app**

Time and calendar are synchronized with those on the smartphone. To get the dedicated app, access download sites of apps for your smartphones. For more information, see the web site below: <https://www.citizenwatch-global.com/support/>

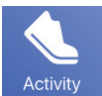

■ **Built-in activity monitor**

The watch records your activity and you can see its data on the dedicated app.



■ **Personalization function**

You can customize up to three extended functions for the watch on the dedicated app and use them on the watch to indicate various information. This extended function is called “iidee”. For more information of iidee, see the web site below: <https://riiiver.com/>



■ **Eco-Drive**

No periodical battery replacement is needed. This watch is fueled by light.



■ **Perpetual calendar**

No need for monthly and leap-year date correction until February 28, 2100.

• "Eco-Drive" is an original technology of Citizen.

CONTENTS

Safety precautions — IMPORTANT 1

Features 1

Before using this watch..... 2

 Connection with the smartphone 2

 Band adjustment..... 2

 Protective stickers 2

 How to use a specially designed crown/button..... 2

Component identification 2

Before connecting with a smartphone..... 2

 Compatible smartphones 2

Pairing (registering) the smartphone 3

 Before pairing 3

 Executing pairing 3

Connection and disconnection..... 3

About time reception 3

Checking the power generation amount and power reserve 4

 Checking power generation amount 4

 Checking the power reserve using the dedicated app 4

Checking the power reserve on the watch..... 5

 Indication of power reserve on the watch 5

Using the activity monitor..... 5

 Data of the activity monitor..... 5

Check the internal temperature of the watch..... 6

Connection indication on the watch 6

 Canceling the connection indication 6

Using iidee 7

 Changing iidee 7

[My watch] screen 7

Removing the data stored in the dedicated app 7

Turning the watch into the flight mode 7

Charging your watch 8

Adjusting the time and calendar manually 9

Troubleshooting 9

 Checking and correcting the reference position 9

 Symptom and remedies 10

 Remove the data stored in the watch 10

Bluetooth 4.0 wireless technology..... 10

Eco-Drive watch handling precautions..... 11

Water resistance 11

Precautionary items and usage limitations 11

Precautionary items and usage limitations (continued) 12

Specifications 12



Before using this watch

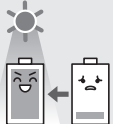

This watch has a rechargeable cell which is charged by exposing the dial to light. Expose the dial to direct sunlight regularly to charge the watch. For details of charging, see page 8 -.

Connection with the smartphone

Use the dedicated app to connect the watch with your smartphone. Download an app compatible with your smartphone from an app store.

Band adjustment

We recommend seeking the assistance of an experienced watch technician for sizing of your watch. If adjustment is not done correctly, the bracelet may unexpectedly become detached leading to loss of your watch or injury (excluding products containing the band adjustment tool). Consult an authorized service center.

Protective stickers



Be sure to remove any protective stickers that may be on your watch (case back, band, clasp, etc.). Otherwise, perspiration or moisture may enter the gaps between the protective stickers and the parts, which may result in a skin rash and/or corrosion of the metal parts.

How to use a specially designed crown/button

Some models are equipped with a specially designed crown and/or push button to prevent accidental operation.

■ Screw down crown/button

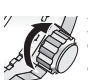
Unlock the crown/button prior to operate your watch.

	Unlock	Lock
Screw down crown	 Rotate the crown counterclockwise until it releases from the case.	 Push the crown in to the case. With gentle pressure towards the case, rotate the crown clockwise to secure it to the case. Be sure to tighten firmly.
Screw down push button	 Rotate the locking screw counterclockwise, and loosen until it stops.	 Rotate the locking screw clockwise, and tighten firmly.

■ Recessed button

Press the button with a non-marring narrow-tipped object.

- Metal objects may cause marring or scratching of the button.

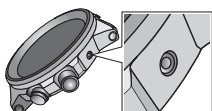

Component identification

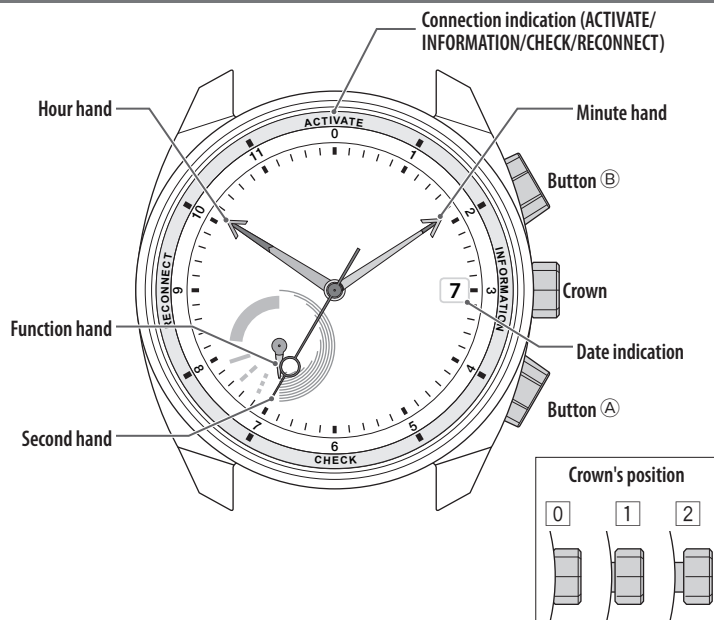

- The illustrations in this instruction manual may differ from the actual appearance of your watch.
- A solar cell is placed under the dial.

Before connecting with a smartphone

This watch communicates with smartphones through Bluetooth Low Energy power-saving communication technology.

You must install the dedicated app "CITIZEN Eco-Drive W510" on your smartphone and start it to make pairing (registration) between the phone and the watch to connect them.

The flow of connection is as follows.

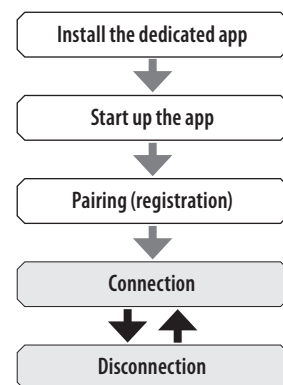

* The Bluetooth® word mark and logos are registered trademarks owned by Bluetooth SIG, Inc.

* Android is a registered trade mark of Google Inc.

* iOS is a name of an operating system of Apple Inc. IOS is a trademark or registered trademark of Cisco in the U.S. and other countries and is used under license.

Compatible smartphones

You can see information about compatible smartphones (compatible with Android OS 8.0/iOS 12.0 or newer) and the dedicated app at the link below.

<https://www.citizenwatch-global.com/support/>



Pairing (registering) the smartphone

Execute pairing at first when connecting the watch and your smartphone.

Before pairing

- Unique pairing information is saved on the watch and smartphone as pairing is executed.
- When you execute pairing anew on a watch which has pairing information, the existing information is removed and new one is saved.

Executing pairing

- For pairing, you have to operate both the watch and the smartphone.
- It takes about 5 seconds to pair the watch and the smartphone.

1 Download the dedicated app "CITIZEN Eco-Drive W510" at an app site and install it.

2 Start the dedicated app.

- Keep the app screen displayed until pairing is finished.
- If you have never logged in before, make an account on the login screen. After finishing initial settings after making an account, the pairing screen appears.



When the screen on the left does not appear after logging in, tap the menu icon on the upper right of the home screen.



After that, tap [My watch] - [Adding a new watch].

3 Press and release upper right button (B) and lower right button (A) at the same time.

The second hand of the watch points "ACTIVATE" and pairing starts.

■ When pairing finished successfully

The second hand of the watch turns fully around twice and the watch and smartphone are connected.

- When firmware update for the watch is available, apply it as soon as possible. You can execute firmware update using [My watch] on the menu screen.

■ When pairing failed

The watch emits alarm sound and its second hand points "RECONNECT" of the connection indication and stops.

- Press any of the buttons of the watch to cancel the connection indication before you try pairing again.

Connection and disconnection

After pairing, the status between the watch and smartphone is either "connected" or "disconnected".

This watch and the smartphone is not always connected. Connect them as required when using the watch or the dedicated app. They are automatically disconnected as using of iidea was finished or sending and receiving of required information such as time information.

- For "connection", the dedicated app must be running on your smartphone (running in the background is OK).

■ Connecting

1 Start the dedicated app.

2 Press and release upper right button (B) and lower right button (A) at the same time.

The watch and the smartphone are connected.

■ Disconnecting manually

Set the crown to position [1] or [2].

About time reception

This watch receives time information from your smartphone at every connection and adjusts the time and calendar automatically.

In addition, the watch makes temporary connection with the smartphone automatically once a day to adjust time and calendar even after disconnection when it is exposed with light after 3:00 AM on it (automatic time reception).

- Pairing with a smartphone is previously required for the automatic time reception.
- When the watch is saving power (page 8), the automatic time reception will start as the power save is canceled.
- Automatic time information reception function does not work in the following cases:
 - When the crown is not at position [0].
 - Power reserve level of the watch is "0" (during insufficient charge warning).



Checking the power generation amount and power reserve

You can check the power generation amount and power reserve of the watch on the dedicated app.

- Data of power generation and power reserve are stored in the watch for up to 2 weeks and removed from older one.

Checking power generation amount

- The power generation amount is indicated in the achievement level. The achievement level is percentage value when power generation amount required to charge power for 1-day running is supposed 100 %.
- You can check history of power generation amount in graphs and maps.

1 Start the dedicated app.

2 Press and release upper right button (B) and lower right button (A) at the same time.

The watch and the smartphone are connected.

3 Display the screen of power generation amount.



Tap the icon.

4 Check information on the screen of power generation amount.

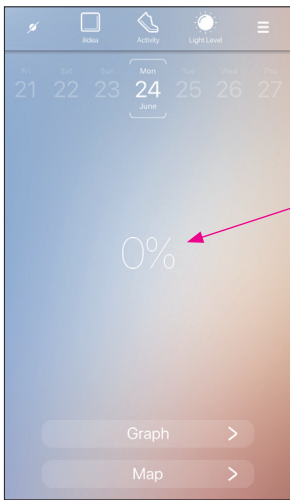

Achievement level

Power generation amount required to charge power for 1-day running with standard use of a smartphone is supposed 100 %.

- Charging amount becomes less even when achievement level is 100% if you use the watch more with your smartphone.
- See [Specifications](#) for details of “Standard use with the smartphone”.
- Tap [Graph] or [Map] to indicate power generation amount with daily/weekly/monthly line graphs or lines on a map.

Checking the power reserve using the dedicated app

1 Start the dedicated app.

2 Press and release upper right button (B) and lower right button (A) at the same time.

The watch and the smartphone are connected.

3 Tap the menu icon on the home screen of the dedicated app.



Tap the icon.

4 Tap [My watch].

- The current power reserve level is indicated when the watch and the smartphone are connected.

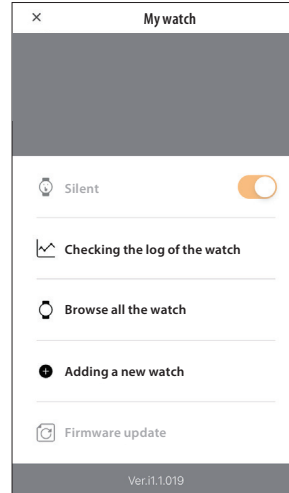

5 Tap [Checking the log of the watch].

The screen of power reserve and temperature of the watch is indicated.

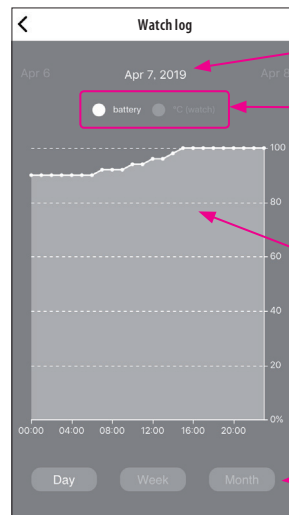

Tap to switch indication time period.

Tap to switch indication between [battery] (power reserve) and [°C (watch)] (temperature of the watch).

Points of the graph show average in time period indicated.

Tap to switch unit of indication time period.



Checking the power reserve on the watch

- Power reserve is indicated in 29 levels.

1 Press the lower right button (A) repeatedly to make the function hand indicate power reserve.

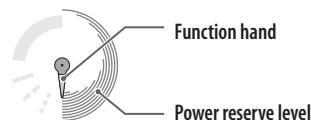

Indication of power reserve on the watch

Power reserve is indicated with the function hand in percentage.

	Indication	Duration (approx.)		Meaning
		When using connection	When not using connection	
100%		7 months	1 year	Power reserve is sufficient.
50%		5 months	9 months	Charged about half amount.
0%		Connection is unavailable.	18 days	Charge immediately.
		<ul style="list-style-type: none"> At 0%, the second hand starts to move once every two seconds ("When the watch reaches a low charge state (insufficient charge warning function)"). 		

- See the table of "Standard use with the smartphone" in "Specifications" for details such as usage conditions of "When using connection" of duration.
- Connection is disconnected when the power reserve becomes "0%". However, basic functions of the watch are still available.
- Some basic functions become unavailable while the insufficient charge warning function is active.

Using the activity monitor

An acceleration sensor is equipped with this watch and your activity is automatically measured and the data are stored.

When the watch and the smartphone are connected, the activity data are sent to the smartphone. The data can be browsed and saved on the dedicated app.

- The activity data are stored in the watch for 2 weeks and removed from older one.

1 Start the dedicated app.

2 Press and release upper right button (B) and lower right button (A) at the same time.

The watch and the smartphone are connected.

3 Display the screen of activity monitor.



4 Check information on the screen of activity monitor.



- Achievement level**
Target value set is supposed 100%.
- Tap [Graph] to indicate activity amount with daily/weekly/monthly line graphs.

* Software technologies provided by ACOS CO., LTD () are used on the activity monitor on this watch.

* Activity amount indicated on the activity monitor may differ from the actual one depending on usage of the watch. Please use this table as a reference only.

Data of the activity monitor

To use the activity monitor correctly, it is required to enter personal data of your body (sex, height, weight and birth date).

These data are stored in the watch and the app together with activity data (count of steps, calorie consumption, etc.).

See "Remove the data stored in the watch" to remove the data above.

Check the internal temperature of the watch

A temperature sensor is equipped with this watch.

When the watch and the smartphone are connected, data of temperature sensor are sent to the smartphone. The data can be browsed on the dedicated app.

- The temperature indicated is that in the watch. It may be different from environmental temperature especially when you wear the watch. When you want to know environmental temperature, take off the watch and wait until the temperature in the watch goes near to environmental one.
- The temperature data measured are stored in the watch for 2 weeks and removed from older one.
- Temperature measurement result is indicated with about ± 5 °C accuracy when environmental temperature is $+5$ °C - $+35$ °C. Please use this table as a reference only.
- The temperature unit used (°C/°F) follows the setting of the smartphone.

1 Start the dedicated app.

2 Press and release upper right button **B** and lower right button **A** at the same time.

The watch and the smartphone are connected.

3 Tap the menu icon on the home screen of the dedicated app.



4 Tap [My watch].

5 Tap [Checking the log of the watch].

The screen of power reserve and temperature of the watch is indicated.

6 Tap [°C (watch)] to switch indication to temperature of the watch.

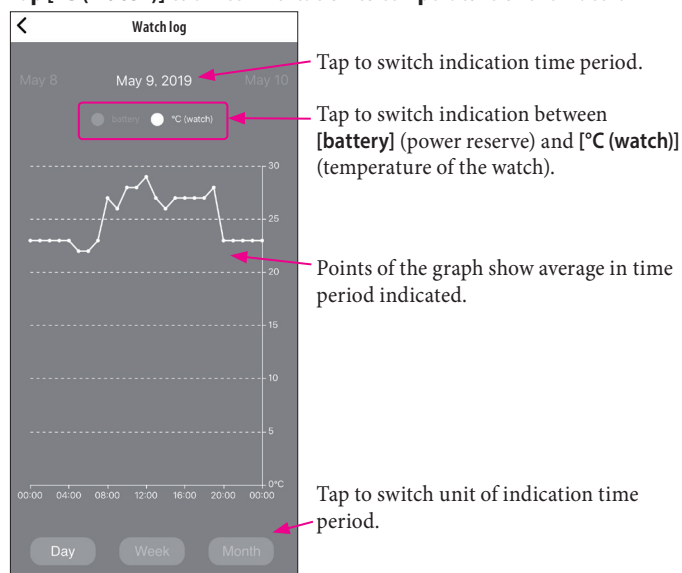

Connection indication on the watch

When the connection status with the smartphone changed, the second hand points a connection indication of current status and stops.

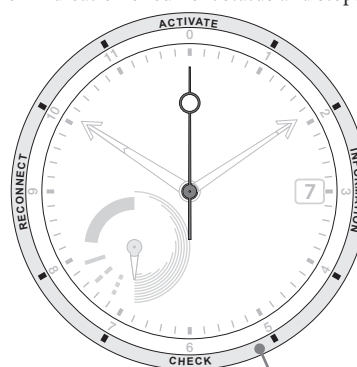

Connection indication with the second hand

Indication	Second hand position	Meaning
ACTIVATE	0 seconds	During connection process
INFORMATION	15 seconds	Indication when communication with the dedicated app occurred
CHECK	30 seconds	Indication of an error of an iiidea
RECONNECT	45 seconds	Failed pairing/accidental disconnection

- Connection indication is indicated only when the crown is in position **0**. When the watch cannot indicate connection indication, indicating it is postponed until it can.
- The watch keeps correct time and calendar even while the second hand indicates connection indication.
- The “INFORMATION” indication may notify update of the dedicated app.

■ Connectable range

Connectable distance between the watch and the smartphone is up to about 10 m (33 feet). Connectable range may be shorter due to obstacles such as walls. Do not block the watch with your body such as by crossing your arms.

Canceling the connection indication

The second hand does not indicate the second until you operate the watch to cancel connection indication.

- Previous canceling of connection indication may be required for some operation.
- Canceled connection indication cannot be shown again.

1 Press and release any of the buttons while the second hand indicates connection indication.

The connection indication is canceled and the second hand returns to normal movement.

- Changing the position of the crown also cancels the connection indication.



Using iiidea

The dedicated app has 3 slots to register iiideas. You can add iiideas which have functions you want to the slots and operate them from the watch or show their indication on the watch.

- The conditions for use vary for each iiidea. By tapping the iiidea icon of the dedicated app, you can check them.

For more information of iiidea, see the web site below:

<https://riiiver.com/>

Changing iiidea

- Start the dedicated app.
- Press and release upper right button **(B)** and lower right button **(A)** at the same time.
The watch and the smartphone are connected.
- Press the lower right button **(A)** repeatedly to switch iiidea to what you want to use.

- Move the function hand so that it will point the slot of the iiidea you want to use.

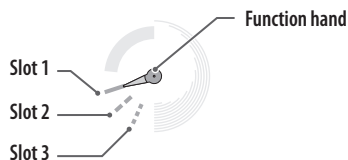

- Slots which no iiideas are registered to on the dedicated app are skipped.

To stop using an iiidea

Press the lower right button **(A)** repeatedly to make the function hand indicate power reserve.

[My watch] screen

You can modify various settings on the [My watch] screen on the dedicated app.

- Some settings are not available without connection between the watch and the smartphone.

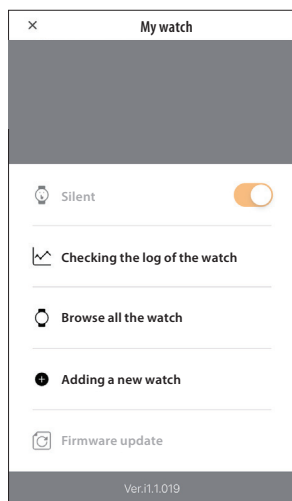

Silent	The watch emits no sound while it is activated.
Checking the log of the watch	Power reserve and temperature of the watch are indicated in graphs.
Browse all the watch	The currently-connected watch and others are indicated.
Adding a new watch	Tap here when executing pairing.
Firmware update	Use it when updating firmware of the watch.

Removing the data stored in the dedicated app

Data stored in the cloud and the dedicated app on the smartphone can be removed from the setting screen of the app → [Account setting] → [Data deleting].

- See “[Remove the data stored in the watch](#)” when removing the data stored in the watch.

Turning the watch into the flight mode

You can deactivate the function to connect with a smartphone when required such as in a plane or a hospital.

1 Pull the crown out to position 1.

The second hand shows the current setting of the flight mode (on/off).

- If connected, connection with the smartphone is disconnected

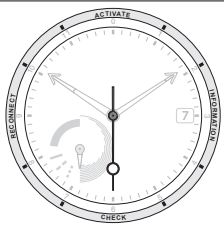
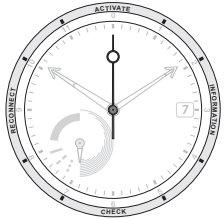
	Indication	Second hand position	Meaning
On		30 seconds	The flight mode setting is turned on and the connection function becomes unavailable. Automatic time reception also becomes unavailable.
Off		0 seconds	The flight mode setting is turned off and the connection function becomes available.

2 Rotate the crown to change the setting of the flight mode.

Off → On: Rotate the crown clockwise.

On → Off: Rotate the crown counterclockwise.

3 Push the crown in to position 0 to finish the procedure.

The watch returns to normal indication.

After turning off the flight mode setting

The connection function of the watch becomes available as the flight mode setting is turned off.

Execute connection operation when you want to connect it with the smartphone.

- Check the time and calendar of the watch and adjust them if required.



Charging your watch

This watch has a solar cell under the dial and stores the power generated by the cell in its built-in rechargeable cell.

The cell is charged by exposing the dial to light such as direct sunlight or fluorescent lamps.

For optimal performance, be sure to:

- Put the watch in a location where the dial is exposed to bright light such as by the window even when it is not used.
- Expose its dial to direct sunlight for 5 or 6 hours at least every week.
- Avoid leaving it in dark places for long periods of time.

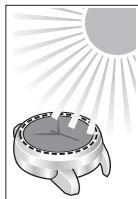

CAUTION

- Do not charge the watch at a high temperature (about 60°C (140°F) or higher) as doing so may cause movement malfunction.
- If the watch is obscured from light by long sleeves frequently, supplemental charging may be needed to ensure continual operation.
- The watch stops charging automatically after finishing (overcharging prevention function). The function prevents damage to performance of the watch and rechargeable cell due to overcharging.

When the watch reaches a low charge state (insufficient charge warning function)

When the power reserve becomes low, the second hand moves once every two seconds. This is the insufficient charge warning function. Be sure to fully charge your watch immediately as outlined below.

- When the watch is sufficiently charged, the second hand will move normally.
- If you do not charge the watch for 18 days or longer after the insufficient charge warning movement has begun, the watch will be depleted of all power and stop.

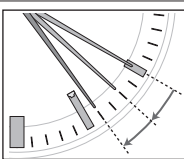

During the insufficient charge warning state

The time and date are indicated correctly.

Charging time by environment

Below are the approximate charging times when exposing to light continuously. Please use this table as a reference only.

Environment	Outdoors (sunny)	Outdoors (cloudy)	20cm (7-7/8 inches) away from a fluorescent lamp (30W)	Interior lighting
Illuminance (lx)	100,000	10,000	3,000	500
To work for one day	6 minutes	19 minutes	1.5 hours	6.5 hours
To start working normally when the cell is discharged	3 hours	12 hours	40 hours	–
To become fully charged when the cell is discharged	25 hours	60 hours	–	–

- Exposing to direct sunlight is recommended to charge your watch. A fluorescent lamp or interior lighting does not have sufficient illumination to charge the rechargeable cell efficiently.

After charged fully, the watch runs without additional charging

Using with a smartphone	7 months*
Using with no smartphones	About 1.0 year
Power save function kept activated	About 1.1 years

* See the table of "Standard use with the smartphone" in "Specifications" for details such as usage conditions of "Using with a smartphone".

Cautions when connected with a smartphone

- Frequent connection with a smartphone and frequent use of *iiideas* consume much amount of power. Charge the watch frequently.
- Take also care that your smartphone is charged enough.

Power save function

The second hand stop automatically at 0 seconds to save power when the dial of the watch has not been exposed to light for 30 minutes.

- However, automatic time reception is not executed while saving power.
- The power save function is not activated when the position of the crown is not .

Canceling the power save function

The power save status ends and the hands return to normal indication in the following cases:

- The dial is exposed to light and power generation starts.
- Activity is detected and measured through the acceleration sensor of the watch (when data of your body had already been registered).

After power saving of a long period of time, check the time and calendar of the watch and adjust them if required.



Adjusting the time and calendar manually

- If connected, connection with the smartphone is disconnected

1 Pull the crown out to position 2.

The second hand points 15 seconds.

2 Press and hold the upper right button (B) for 2 seconds.

The second hand points 0 seconds.

- Release the button as the second hand points 0 seconds.

3 Press the lower right button (A) to change the target to correct.

- Each time you press the lower right button (A), the target changes as follows.

Minute → hour → date → year/month → (back to the top)

- The hands and indications slightly move when selected to show they become adjustable.

4 Rotate the crown to adjust the hand/indication.

- Change of date indication shows it just became AM. Take care the time set is AM or PM.

- The function hand moves synchronously with the date indication.

- When you rotate the crown quickly a few times, the minute/hour hands and date indication will move continuously. To stop the rapid movement, rotate the crown in either direction.

- Refer to "Month and year indications" to set the year and month.

5 Repeat steps 3 and 4.

6 Push the crown in to position 0 in accordance with a reliable time source to finish the procedure.

■ Month and year indications

Set the year and month with the position of the second hand.

"Month" corresponds to one of the 12 zones shown in the figure below.

Each number means month.

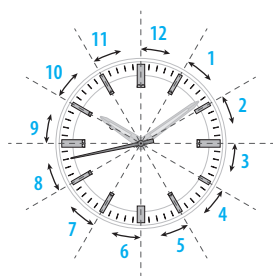

"Year" corresponds to the years since leap year and is indicated with markers in the zone of each month.

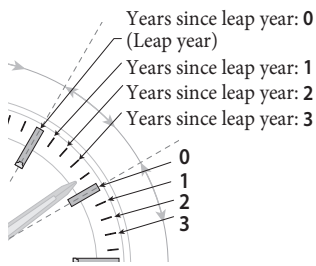

Year					Years since leap year	Second hand position
2016	2020	2024	2028	2032	0 (Leap year)	Hour marker
2017	2021	2025	2029	2033	1	1st min. marker
2018	2022	2026	2030	2034	2	2nd min. marker
2019	2023	2027	2031	2035	3	3rd min. marker



Ex.: Position of the second hand when setting July 2019

You can find that the years since leap year of 2019 is "3" from the table and the second hand must be set to the 3rd minute marker of July zone.

Troubleshooting

Checking and correcting the reference position

You can check and adjust the reference position through the dedicated app. Connect the watch with the smartphone and tap [Help] → [Troubleshooting] → [Time and/or date is incorrect] from the menu screen of the dedicated app.

If the time or calendar is not shown correctly even after proper reception of the time info, check whether the reference position is correct.

- If the hands and indication do not reflect the correct reference position, the time and calendar will not be indicated accurately even if the time info is received.
- Be sure to check the current reference position and adjust it only when the position is not correct.

What is the reference position?

The base position of all hands and calendar to properly indicate the various functions of this watch.

- Hour, minute and second hands: 0 hour 00 minute 0 second
- Function hand: slot 1
- Date indication: Midway between "31" and "1"

Correct reference positions

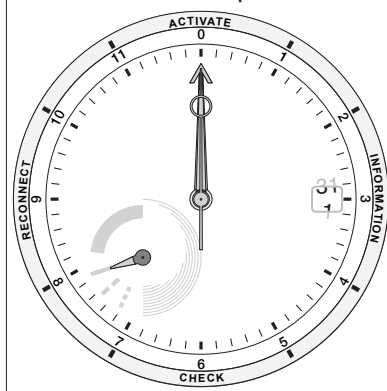

1 Pull the crown out to position 2.

The second hand points 15 seconds.

2 Press and hold the lower right button (A) for 4 seconds or more.

The hands and indication start to move to the current reference positions stored in memory.

- Release the button as the hands/indication start to move.
- Proceed to the next step after the hands/indication stop.

3 Check the reference positions of them referring to the illustration above.

Correct	Proceed to step 8 without adjusting the reference position.
Wrong	Proceed to step 4 and correct the reference position.

4 Press and release the lower right button (A) to start adjustment of the reference position.

5 Press and release the lower right button (A) repeatedly to change the hand/indication to be corrected.

- Each time you press the lower right button (A), the target changes as follows. Function hand/date indication → hour hand → minute hand → second hand → (back to the top)
- The hands slightly move when selected to show they become adjustable.

6 Rotate the crown to adjust the hand/indication.

- The function hand and date indication move synchronously. Date indication changes to the next as the function hand rotates 5 times.
- When adjusting the hour hand, the second and minute hands slightly escape left and right to provide clearer view of the hour hand.
- When you rotate the crown quickly a few times, the hand/indication will move continuously. To stop the rapid movement, rotate the crown in either direction.

7 Repeat steps 5 and 6.

8 Push the crown in to position 0.

The watch keeps to indicate the reference position.

9 Press and release the lower right button (A) to finish the procedure.

Symptom and remedies

Symptom	Remedies	Page
Connection with the smartphone		
Connection is unsuccessful.	Check the position of the crown of the watch.	—
	Check power reserve.	4
	Check the flight mode setting of the watch.	7
	Cancel the connection indication.	6
	Start the dedicated app.	—
	Check the Bluetooth settings of your smartphone.	—
	Avoid anything that will block out the radio wave or generate noise.	—
	Remove the pairing information (Eco-Drive Riiiver) on your smartphone and try pairing again.	—
Cannot execute pairing.	Check the flight mode setting of the watch.	7
	Remove the pairing information (Eco-Drive Riiiver) on your smartphone and try pairing again.	—
	Charge the watch.	8
The icon is colored pale and some screens of the app cannot be opened.	Connect with the smartphone.	—
Not notified within connectable distance	Check the power reserve of the watch.	4
	Check the flight mode setting of the watch.	7
	Start the dedicated app.	—
	Check the notification setting of the dedicated app.	—
	Avoid anything that will block out the radio wave or generate noise.	—
No notification sound is emitted.	Turn on [Silent] at [My watch] on the dedicate app.	—
Connection is disconnected during setting.	Check the power reserve of the watch.	4
	Start the dedicated app.	—
	Check whether the smartphone exists within the connectable range (a few meters (some 10 feet) or so).	—
	Avoid anything that will block out the radio wave or generate noise.	—
Time info cannot be obtained automatically.	Check the position of the crown.	—
	Check the power reserve of the watch.	4
	Check the flight mode setting of the watch.	7
	Confirm that the watch is not in power save status.	8
	Start the dedicated app.	—
	Check whether the smartphone exists within the connectable range (a few meters (some 10 feet) or so).	—
	Avoid anything that will block out the radio wave or generate noise.	—
Movement of a hand seems strange		
The hands rotate rapidly soon after you take the watch out of a case or something similar.	The power save function is canceled. Wait until the current time is displayed.	—
The hands move in an unexpected direction.	Wait until the watch returns to normal movement.	—
The second hand does not move.	Cancel the connection indication.	6
	Charge the watch.	8
The second hand moves once every two seconds.	Charge the watch.	8
Connection status is not indicated.	Charge the watch.	8
The flight mode setting is not indicated.	Charge the watch.	8

Symptom	Remedies	Page
Time/calendar is abnormal.		
The indication of the time and date is incorrect.	Check settings of iideea.	7
	Check the flight mode setting of the watch.	7
	Check time and calendar of the smartphone.	—
	Obtain time info from the smartphone to adjust time and calendar.	—
	Adjust the time and calendar manually.	9
	Check and correct the reference position.	9

Resetting the watch — All Reset

When the watch does not work properly, you can reset the time and calendar settings. If the power reserve is insufficient, charge the watch first.

Be sure to perform the following operations after All Reset.

1 Correct the reference positions.

After All Reset, the watch is in the reference position adjustment mode. Refer to step 4 and after on page 9.

2 Adjust the time and calendar.

Adjust the time and calendar manually (page 8) or by connecting with your smartphone.

1 Pull the crown out to position 2.**2 Press and hold the lower right button (A) and the upper right button (B) at the same time for 4 seconds or more and release them.**

As you release the buttons, the alarm sounds and all reset is executed.

The setting values after All Reset	
Time	0:00:00AM
Calendar	January 1 of leap year
Pairing information	Pairing information is not removed.
Connection status	Disconnection

Remove the data stored in the watch

Follow the steps below to delete all the data stored in the watch such as pairing information, personal data of your body, data of activity monitor, etc. and returns status of the watch to that when shipped.

1 Pull the crown out to position 1.

The second hand stops pointing 0 seconds (flight mode off) or 30 seconds (flight mode on).

2 Press and hold the upper right button (B) for 4 seconds or more.

The second hand widely swings left and right from the center (0 seconds) and data is removed.

- Release the button when the second hand widely swings left and right.

Bluetooth 4.0 wireless technology**Regulatory concerning to Bluetooth (Areas where Bluetooth is available)**

Use of the Bluetooth communication technology is not legally permitted in some countries or regions. Visit our web site below to confirm the list of countries where Bluetooth is legally available.

<https://www.citizenwatch-global.com/support/>

- Using this watch in a country where it is not permitted may be punished under its law.
- Communication using Bluetooth may be monitored intentionally or accidentally. Do not use this watch for important communication or any communication involving human lives.
- The Bluetooth® word mark and logos are registered trademarks owned by Bluetooth SIG, Inc.



Eco-Drive watch handling precautions

<Always Make Sure to Recharge Frequently>

- For optimal performance, your watch should remain fully charged.
- Long sleeves may inhibit light transmission to your watch. This may result in your watch losing charge. In these cases supplemental charging may be necessary.
- When you take off the watch, place it in a bright location to ensure optimal performance.

CAUTION Recharging Precautions

- Do not charge the watch at a high temperature (about 60 °C (140°F) or higher) as doing so may cause the movement to malfunction.
Ex.:
 - Charging the watch too close to a light source which generates a large amount of heat such as an incandescent lamp or halogen lamp. When charging under an incandescent lamp, be sure to leave 50 cm (20 inches) or more between the lamp and the watch to avoid exposing the watch to excessive heat.
 - Charging the watch in a location where the temperature may become extremely high such as on the dashboard of a vehicle.

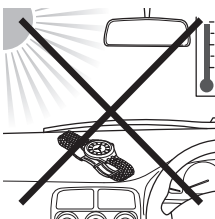

<Replacement of Rechargeable Cell>

- This watch utilizes a special rechargeable cell that does not require periodical replacement. However power consumption may increase after using the watch for a number of years due to wear of internal components and deterioration of oils. This may cause stored power to be depleted at a faster rate.

WARNING Handling of Rechargeable Cell

- The rechargeable cell should never be removed from the watch. If for any reason it becomes necessary to remove the rechargeable cell from the watch, keep out of the reach of children to prevent accidental swallowing. If the rechargeable cell is accidentally swallowed, consult a doctor immediately.
- Do not dispose of the rechargeable cell with ordinary garbage. Please follow the instructions of your municipality regarding collection of batteries to prevent the risk of fire or environmental contamination.

WARNING Use Only the Specified Battery

- Never use a battery other than the rechargeable cell specified for use in this watch. Although the watch structure is designed so that it will not operate when another type of battery is installed, if a conventional watch battery or other type of battery is installed in the watch and the watch is recharged, there is the risk of overcharging which may cause the battery to rupture. This can cause damage to the watch and injury to the wearer. When replacing the rechargeable cell, always make sure to use the designated rechargeable cell.

Water resistance

WARNING Water resistance

- Refer to the watch dial and/or the case back for the indication of the water resistance of your watch. The following chart provides examples of use for reference to ensure that your watch is used properly. (The unit "Ibar" is roughly equal to 1 atmosphere.)
- WATER RESIST(ANT) x×bar may also be indicated as W.R.x×bar.
- Non-water resistant models are not designed to come into contact with any moisture. Take care not to expose a watch with this rating to any type of moisture.
- Water resistance for daily use (to 3 atmospheres) means the watch is water resistant for occasional accidental splashing.
- Upgraded water-resistance for daily use (to 5 atmospheres) means that the watch may be worn while swimming, but is not to worn while skin diving.
- Upgraded water-resistance for daily use (to 10/20 atmospheres) means that the watch may be worn while skin diving, but not while scuba or saturated diving using helium gas.

Name	Indication	Specification	Water-related use					
	Dial or Case back		Minor exposure to water (washing face, rain, etc.)	Swimming and general washing work	Skin diving, marine sports	Scuba diving using an air tank	Saturation diving using helium gas	Operate the crown or button when the watch is wet
Non-water resistant	—	Non-water resistant	NO	NO	NO	NO	NO	NO
Everyday-use water resistant watch	WATER RESIST	Water-resistant to 3 atmospheres	OK	NO	NO	NO	NO	NO
Upgraded everyday use water resistant watch	W. R. 5 bar	Water-resistant to 5 atmospheres	OK	OK	NO	NO	NO	NO
	W. R. 10 bar W. R. 20 bar	Water-resistant to 10 and 20 atmospheres	OK	OK	OK	NO	NO	NO

Precautionary items and usage limitations

CAUTION To Avoid Injury

- Be particularly careful when wearing your watch while holding a small child, to avoid injury.
- Be particularly careful when engaged in strenuous exercise or work, to avoid injury to yourself and others.
- Do NOT wear your watch while in a sauna or other location where your watch may become excessively hot, since there is the risk of burns.
- Be careful when putting on and taking off your watch, since there is a risk of damaging your fingernails, depending on the manner in which the band is fastened.
- Take off your watch before going to bed.

CAUTION Precautions

- Always use the watch with the crown pushed in (normal position). If the crown is of the screw lock-type, make sure it is securely locked.
- Do not operate (use the crown and/or buttons) the watch when it is wet. Water may enter the watch causing damage to vital components.
- If water enters the watch or the watch fogs up and does not clear up even after a long time, consult your dealer or an authorized service center for inspection and/or repair.
- Even if your watch has a high level of water resistance, please be careful of the following.
 - If your watch is immersed in sea water, rinse thoroughly with fresh water and wipe with a dry cloth.
 - Do not pour water from a tap directly onto your watch.
 - Take off your watch before taking a bath.
- If seawater enters the watch, place the watch in a box or plastic bag and immediately take it in for repair. Otherwise, pressure inside the watch will increase, and parts (crystal, crown, push button, etc.) may come off.

CAUTION When Wearing Your Watch

<Band>

- Leather bands and rubber (urethane) bands will deteriorate over time due to perspiration or dirt. In addition, they are made of natural material and will be worn, deformed and discolored over time. It is recommended to replace the band periodically.
- The durability of a leather band may be affected when wet (fading, peeling of adhesive), owing to the properties of the material. Moreover, wet leather may cause a rash.
- Do not stain a leather band with substances containing volatile materials, bleach, alcohol (including cosmetics). Discoloration and premature aging may be occurred. Ultraviolet light such as direct sunlight may cause discoloration or deformation.
- It is recommended to take off the watch if it gets wet, even if the watch itself is water-resistant.
- Do not wear the band too tightly. Try to leave enough space between the band and your skin to allow adequate ventilation.
- The rubber (urethane) band may be stained by dyes or soil present in or on clothing or other accessories. Since these stains may not be removable, caution is required when wearing your watch with items that tend to easily transfer color (articles of clothing, purses, etc.). In addition, the band may be deteriorated by solvents or moisture in the air. Replace with a new one when it has lost elasticity or become cracked.
- Please request adjustment or repair of the band in the following cases:
 - You notice an abnormality with the band due to corrosion.
 - The pin of the band is protruding.
- We recommend seeking the assistance of an experienced watch technician for sizing of your watch. If adjustment is not done correctly, the bracelet may unexpectedly become detached leading to loss of your watch or injury. Consult an authorized service center.

<Temperature>

- The watch may stop or the function of the watch may be impaired in extremely high or low temperature. Do not use the watch in places where the temperature is outside the operating temperature range as stated in the specifications.

<Magnetism>

- Analog quartz watches are powered by a step motor that uses a magnet. Subjecting the watch to strong magnetism from the outside can cause the motor to operate improperly and prevent the watch from keeping time accurately. Do not allow the watch to come into close proximity to magnetic health devices (magnetic necklaces, magnetic elastic bands, etc.) or the magnets used in the latches of refrigerator doors, clasps used in handbags, the speaker of a cell phone, electromagnetic cooking devices and so on.

<Strong Shock>

- Avoid dropping the watch or subjecting it to other strong impact. It may cause malfunctions and/or performance deterioration as well as damage to the case and bracelet.

<Static Electricity>

- The integrated circuits (IC) used in quartz watches are sensitive to static electricity. Please note the watch may operate erratically or not at all if exposed to intense static electricity.

<Chemicals, Corrosive Gasses and Mercury>

- If paint thinner, benzene or other solvents or products containing these solvents (including gasoline, nail-polish remover, cresol, bathroom cleaners and adhesives, water repellent, etc.) are allowed to come into contact with the watch, they may discolor, dissolve or crack the materials. Be careful when handling these chemicals. Contact with mercury such as that used in thermometers may also cause discoloration of the band and case.

<Protective Stickers>

- Be sure to remove any protective stickers that may be on your watch (case back, band, clasp, etc.). Otherwise, perspiration or moisture may enter the gaps between the protective stickers and the parts, which may result in a skin rash and/or corrosion of the metal parts.



Precautionary items and usage limitations (continued)

CAUTION Always Keep Your Watch Clean

- Rotate the crown while it is pressed in fully and press the buttons periodically so they do not become stuck due to accumulations of foreign matter.
- The case and band of the watch come into direct contact with the skin. Corrosion of the metal or accumulated foreign matter may result in black residue coming from the bracelet when exposed to moisture or perspiration unnoticed soiling such as that caused by perspiration. Be sure to keep your watch clean at all times.
- Be sure to periodically clean the bracelet and case of your watch to remove accumulated dirt and foreign matter. In rare circumstances, accumulated dirt, foreign matter may cause irritation with the skin. If you notice this, discontinue wearing the watch and consult your physician.
- Be sure to periodically clean foreign matter and accumulated materials from the metal band, synthetic rubber strap (polyurethane) and/or metal case using a soft brush and mild soap. Be careful not to allow moisture on the case if your watch is not water resistant.
- Leather bands may become discolored by perspiration or dirt. Always keep your leather band clean by wiping with a dry cloth.

Caring for Your Watch

- Wipe any dirt or moisture such as perspiration from the case and crystal with a soft cloth.
- For a metallic, plastic or synthetic rubber (polyurethane) band, clean it with soap and a soft toothbrush. Be sure to thoroughly rinse the band after cleaning to remove any soap residue.
- For a leather band, wipe off dirt using a dry cloth.
- If you will not be using your watch for an extended period of time, carefully wipe off any perspiration, dirt or moisture and store in a proper location, avoiding locations subject to excessively high or low temperatures and high humidity.

When Luminous Paint is used for your watch

The paint on the dial and hands helps you with reading the time in a dark place. The luminous paint stores light (daylight or artificial light) and glows in a dark place.

It is free from any radioactive substance or any other material harmful to a human body or environment.

- The light emission gradually becomes weaker as time passes.
- The duration of the light ("glow") will vary depending on the brightness, types of and distance from a light source, exposure time, and the amount of the paint.
- The paint may not glow and/or may dissipate quickly if exposure to light was not sufficient.

Specifications

Model	W510	Type	Analog solar-powered watch
Timekeeping accuracy (without reception)	Average monthly accuracy: ± 15 seconds when worn at normal operating temperatures between $+5^{\circ}\text{C}$ (41°F) and $+35^{\circ}\text{C}$ (95°F)		
Operating temperature range	-10°C (14°F) to $+60^{\circ}\text{C}$ (140°F)		
Display functions	Time	Hours, minutes, seconds	
	Calendar	Date	
Duration	After charged fully, the watch runs without additional charging		
	In standard use with a smartphone	About 7 months	
	When connecting with the smartphone and executing automatic time reception once a day	About 7 months	
	When not using with the smartphone	About 1.0 year	
	When power save functions all the day	About 1.1 years	
Battery	Power reserve upon insufficient charge warning function		
	Approximately 18 days		
Additional functions	Rechargeable cell (lithium button cell), 1pc.		
	<ul style="list-style-type: none"> • Solar power function • Power reserve indication (in 29 levels) • Overcharging prevention function • Insufficient charge warning function (two-second interval movement) • Energy saving function (power save feature) • Indication functions about smartphone connection <ul style="list-style-type: none"> - Indication of ongoing communication processing (ACTIVATE) - Notification indication function (INFORMATION) - Indication of an error of an iiidea (CHECK) - Disconnection notification function (RECONNECT) 	<ul style="list-style-type: none"> • Personalization function • Automatic time information reception function • Flight mode function • Perpetual calendar (until February 28th, 2100) • Antimagnetic feature • Impact detection function 	

The following conditions are supposed in the table above as "Standard use with the smartphone".

Power save	4 hours/day
Automatic time reception	Once/day
Acceleration sensor	On: 8 hours/day
	Standby: 12 hours/day Off: 4 hours/day
Using an iiidea	10 times/day

Specifications and contents of this booklet are subject to change without prior notice.

