

ManualsLib.com

1. Features

This watch is a solar-powered watch that contains a solar cell in its face that drives the watch by converting light energy into electrical energy. It is also equipped with numerous functions including a perpetual calendar that changes the date automatically (changes the number of years from the most recent leap year, month, date and day automatically until February 28, 2100 including leap years), a daily alarm that can be set based on a 24 hour clock, and a local time function that enables setting of time differences in one hour units.

2. Before Using

<Be careful not to pull the crown too far out when switching the mode.>
The mode of this watch can be changed with the crown pulled out to Position 1. If the crown is pulled out to Position 2, the second hand will move to the 0 seconds position and the watch will enter the correction mode (when in the time mode or alarm mode; when in the calendar mode, the second hand moves to the month display, and when in the local time mode, the second hand continues to move at 1-

second intervals). **When the crown is pulled out to Position 2 in the time mode, the second hand stops causing the time to be incorrect.** In addition, since the set time, date, alarm time and so forth will end up changing if the crown is pulled out to Position 2 in each mode, be careful not to pull out the crown too strongly. Refer to "5. Switching the Mode (Display Function)" for information on how to properly switch the watch to each mode.

[Crown in Proper Position]

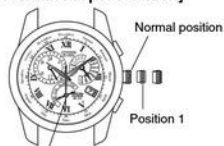

When the crown is pulled out to Position 1, the second hand moves to the 30 seconds position and stops.

[Crown Pulled Out Too Far]



When the crown is pulled out too far to Position 2, the second hand moves to the 0 seconds position and stops, and the watch enters the correction mode.



ManualsLib.com

Name	Crown position	Crown and button operation	
(B) Crown	Normal position	Not used	Not used
	Position 1	Mode switching (second hand stops at 30 seconds position)	Mode switching (second hand stops at 30 seconds position)
	Position 2	Time correction (second hand stops at 00 seconds)	Date correction (second indicates the month)
Button (A)	Normal position	Not used	Function hand indicates years since leap year while pressed
	Position 1	Not used	Not used
	Position 2	Not used	Switches date correction location (leap year → month → date → day)
Button (B)	Normal position	Function hand indicates alarm ON or OFF while pressed	Not used
	Position 1	Not used	Not used
	Position 2	Not used	Not used

Crown and button operation	
Not used	Not used
Mode switching (second hand stops at 30 seconds position)	Mode switching (second hand stops at 30 seconds position)
Alarm correction (second hand stops at 00 seconds)	Local time correction (second hand continues moving in 1-second intervals)
Not used	Switches watch to reference position check mode when pressed continuously for 10 seconds
Not used	Not used
Not used	Not used
Not used	Not used
Alarm tone monitor (alarm tone sounds while pressed)	Not used
Not used	Not used
Alarm ON/OFF setting	Not used



ManualsLib.com



ManualsLib.com



ManualsLib.com

ManualsLib.com

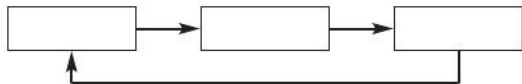

ManualsLib.com

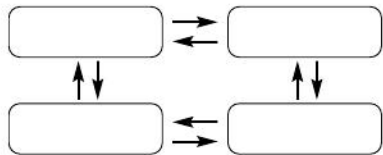
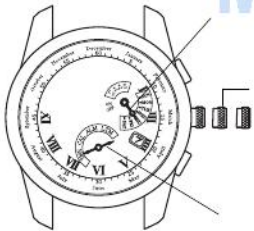

6. Setting the Time



[Procedure for Setting the Time]

1. Pull the crown out to Position 1 (the second hand rapidly advances to the 30 seconds position and waits).

Note: If the second hand does not stop at the 30 seconds position, refer to the section on "Reference Position Correction" of "4. Hand Reference Position Check and Correction" and set the reference position of the second hand.

2. Turn the crown to align the mode hand at the time mode [TME].
3. Pull the crown out to Position 2 (time correction position).
 - The second hand rapidly advances to the 0 seconds position and stops.
4. Turn (click) the crown to set the 24 hour hand, hour hand and minute hand to the current time.
 - ① Turning the crown one click to the right advances the 24 hour hand, hour hand and minute hand by one minute.
 - ② Turning the crown by one click to the left moves back the 24 hour hand, hour hand and minute hand by one minute.
 - Turning the crown continuously (rapidly by two clicks or more) causes the 24 hour hand, hour hand and minute hand to move continuously.
 - Turn the crown to the left or right to interrupt continuous movement of the hands. The hands will continue to advance by 12 hours and then stop automatically unless movement is interrupted by turning the crown to the right or left.
 - The 24 hour hand moves in coordination with the hour hand. Make sure to set AM and PM correctly when setting the time.
5. Return the crown to the normal position in synchronization with a telephone time signal or other time service.

ManualsLib.com

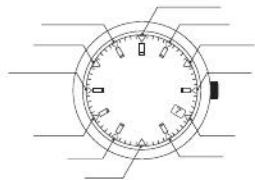

4. Turn (click) the crown to set the year.

- ① Turning the crown to the right causes the year to change in order from LY (leap year) → +1 → +2 → +3 → LY → +1 → and so on.
- ② Turning the crown to the left causes the year to change in the opposite order from LY (leap year) → +3 → +2 → +1 → LY → +3 → and so on.

5. Press button (A).

- The second hand makes one revolution and the watch enters the month correction mode.
- ① Turning the crown one click to the right causes the second hand to advance to the next month.

Note:

- The month can only be corrected by turning the crown to the right (clockwise), and will not be corrected if the crown is turned to the left (counter-clockwise).

6. Press button (A).

- The function hand moves from the year display to the day display and the watch enters the date correction mode.

7. Turn the crown to the set the date.

- ① When the crown is turned by one click to the right, the function hand makes four revolutions and the date changes.
- ② When the crown is turned by one click to the left, the function makes four

revolutions in the opposite direction (counter-clockwise) and the date moves back by one day.

Note:

- The date cannot be corrected continuously. Correct the date one day at a time.
8. Press button (A).
- After the function hand completes a demonstration movement (in which it moves back and forth across the day display range and then stops at the position of the current day), the watch enters the day correction mode.
9. Turn the crown to set the day.
- ① Turning the crown to the right changes the day in the order of SUN → MON → TUE → WED → THU → FRI → SAT and then back to SUN.
 - ② Turning the crown to the left changes the day in the reverse order of SUN → SAT → FRI → THU → WED → TUE → MON and then back to SUN.
10. When button (A) is pressed, the watch returns to the year correction mode.
11. Return the crown to the normal position.
- Following correction of year, month, date or day, the correction mode can be ended by returning the crown to the normal position.
- Example:** After correcting the month, the watch can be returned to the normal display without correcting the date or day by returning the crown to the normal position.
- This completes date correction.

<Change in Corrected Location>



<Quick Reference Chart for Number of Years Since Leap Year>

Year	Elapsed year	Display	Year	Elapsed year	Display
2004	Leap year	LY	2008	Leap year	LY
2005	1st year	+1	2009	1st year	+1
2006	2nd year	+2	2010	2nd year	+2
2007	3rd year	+3	2011	3rd year	+3

<Setting to a Non-Existent Date>

The date is automatically changed to the first day of the following month when the crown is returned to the normal position from the correction mode.

Examples:

Regular year: February 29, 30 or 31 → March 1

Regular year: April 31 → May 1

Leap year: February 30 or 31 → March 1

8. Using the Alarm

The alarm function uses a 24 hour clock. Once the alarm has been set, the alarm sounds for 15 seconds when the set time is reached once a day.

- When using the watch in each of time, calendar and alarm modes, the alarm sounds at the time that coincides with the time mode.
- When using the watch in the local time [L-TM] mode, since the alarm sounds at the time that coincides with the local time, it is not necessary to correct the time difference for the alarm time to coincide with the local time.

[Setting the Alarm Time]

1. Pull the crown out to Position 1 (the second hand rapidly advances to the 30 seconds position and waits).
 - The hour hand and minute hand rapidly advance to the previously set alarm time.
 - The function hand moves to either ON or OFF.
2. Turn the crown to set the mode hand to the alarm mode [ALM].
 - The hour hand and minute hand rapidly advance to the previously set alarm time.
 - The function hand moves to either ON or OFF.
3. Pull the crown out to Position 2 (alarm time setting position).
 - The second hand moves the 0 seconds position.
 - The function hand switches to the ON position.
4. The alarm switches between ON and OFF when button (B) is pressed.
5. Turn the crown to set the alarm time.
 - ① Turning the crown by one click to the right causes the 24 hour hand, hour hand and minute hand to advance by one minute.

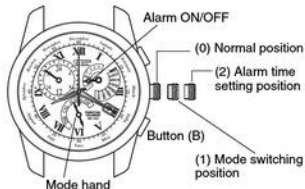

- ② Turning the crown by one click to the left causes the 24 hour hand, hour hand and minute hand to move back by one minute.
 - Turning the crown continuously causes the 24 hour hand, hour hand and minute hand to move continuously.
 - Turn the crown by one click to the left or right to interrupt movement of the hands. The hands will continue to advance by 12 hours and then stop automatically unless their movement is interrupted by turning the crown to the left or right.
 - The 24 hour hand moves in coordination with the hour hand. Make sure to set AM and PM correctly when setting the time.
6. Return the crown to the normal position.

[Switching Alarm ON and OFF]

1. Pull the crown out to Position 1 and then turn the crown to set the watch to the alarm mode [ALM].
 - The hour hand and minute hand rapidly advance to the set alarm time.
 - The function hand moves to either ON or OFF.
2. Pull the crown out to Position 2 (alarm time setting position).
 - The function hand switches to the ON position.
3. The alarm switches between ON and OFF when button (B) is pressed.
4. Return the crown to the normal position after setting the alarm to ON or OFF.

ManualsLib.com

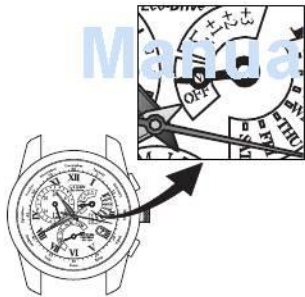

- The second hand rapidly advances to the current time and begins 1-second interval movement.
4. Turn the crown by set the 24 hour hand and hour hand to the local time.
- ① Turning the crown by one click to the right causes the 24 hour hand and hour hand to advance by one hour.
 - ② Turning the crown by one click to the left causes the 24 hour hand and hour hand to go back by one hour.
- Turning the crown continuously (rapidly by two clicks or more) causes the hour hand and minute hand to move continuously.
 - Turn the crown by one click to the left or right to interrupt continuous movement of the hands. The hands will continue to advance by 12 hours and then stop automatically unless movement is interrupted by turning the crown to the right or left.
 - The 24 hour hand moves in coordination with the hour hand. Make sure to set AM and PM correctly when setting the time.
5. Return the crown to the normal position to complete setting of the local time.

10. Functions Unique to Solar-Powered Watches

When the watch becomes insufficiently charged, the watch display changes as shown below. When the watch has changed normal hand movement to the insufficient charge warning display, this indicates that that the watch is insufficiently charged. Allow light to shine on the solar cell until the watch returns to 1-second interval movement. Even after the watch has returned to 1-second interval movement, sufficiently charge the watch by exposing it to light by referring to “11. General Reference for Charging Times” to ensure that the watch is used comfortably.

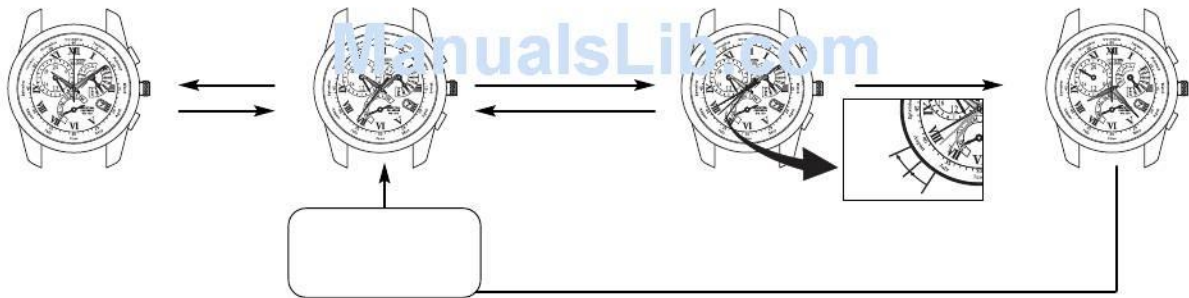



ManualsLib.com



ManualsLib.com

ManualsLib.com

[ManualsLib.com](https://www.ManualsLib.com)



ManualsLib.com



ManualsLib.com

ManualsLib.com

ManualsLib.com