

[REDACTED]

[REDACTED]

[REDACTED]

[REDACTED]

[REDACTED]

[REDACTED]

[REDACTED]

[REDACTED]

[REDACTED]

[REDACTED]

About this Product



About this Product







About this Product



About this Product

About this Product

---

---

---

---

---

---

About this Product

About this Product

.

.

.

.

About this Product



Before Use

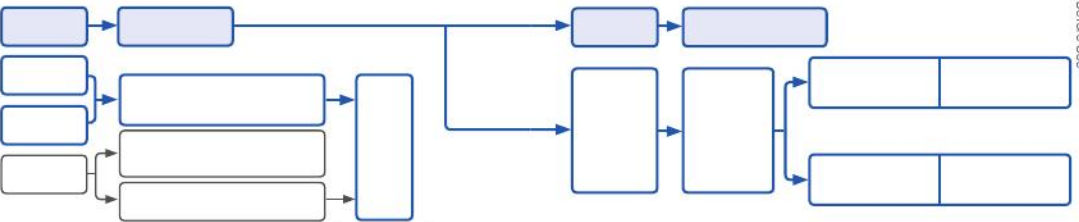

Before Use

How to Get the Time (Radio Signal Reception)

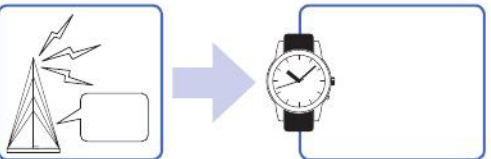

How to Get the Time (Radio Signal Reception)

How to Set the Time Radio Signal Reception

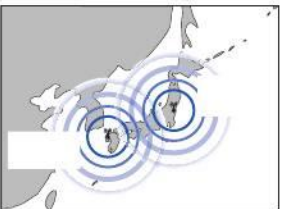

How to Set the Time Radio Signal Reception

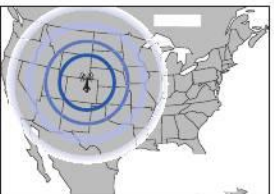

How to Set the Time Radio Signal Reception

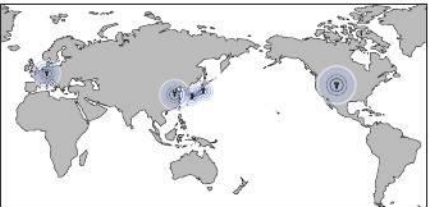

How to Set the Time Radio Signal Reception

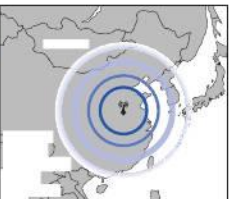

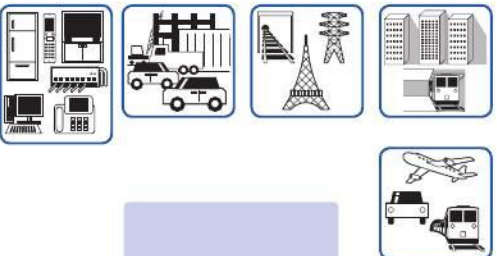
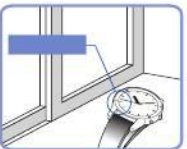



Solar Charging Function

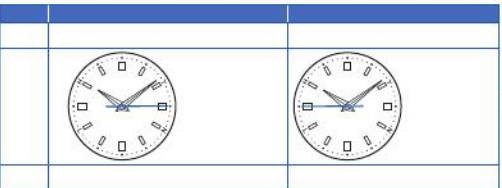

Time difference adjustment  
when using the watch overseas

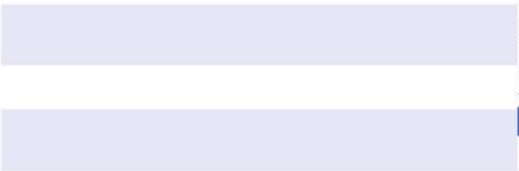

Solar Charging Function



Time difference adjustment  
when using the watch overseas

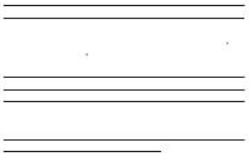



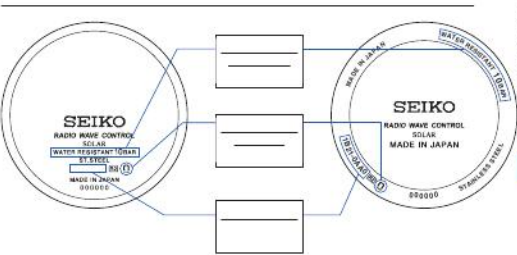

		⚠

---



---



---



To Preserve the Quality of Your Watch

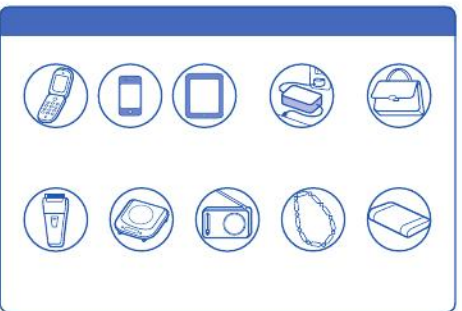

To Preserve the Quality of Your Watch

\_\_\_\_\_

\_\_\_\_\_

\_\_\_\_\_

\_\_\_\_\_

--	--

To Preserve the Quality of Your Watch



To Preserve the Quality of Your Watch

\_\_\_\_\_

\_\_\_\_\_

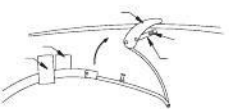
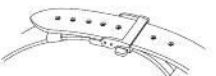
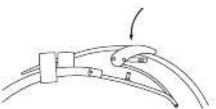
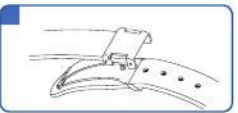
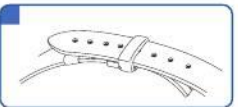
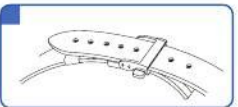
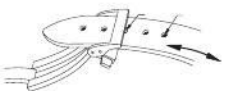
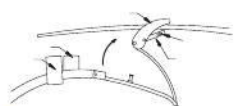
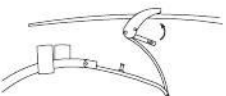
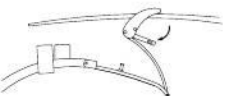
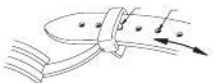
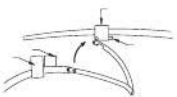
\_\_\_\_\_

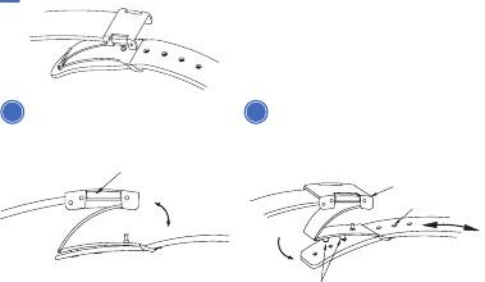



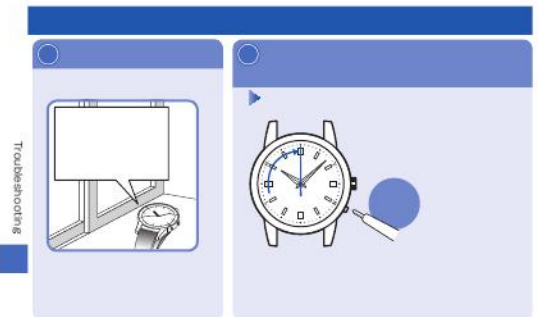
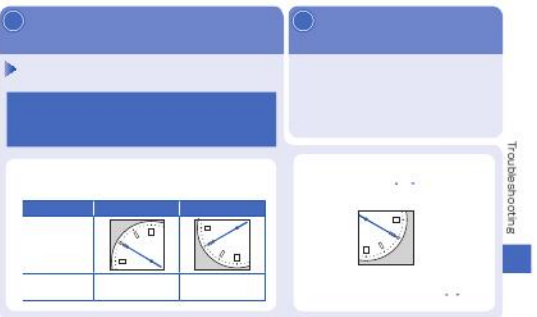



Troubleshooting

[Empty white rectangular box]

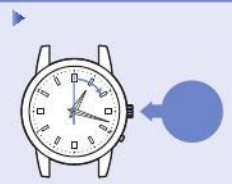

Troubleshooting



Troubleshooting



[Two empty horizontal lines for text entry]

Troubleshooting

Troubleshooting							

Troubleshooting



Troubleshooting

Troubleshooting



Troubleshooting

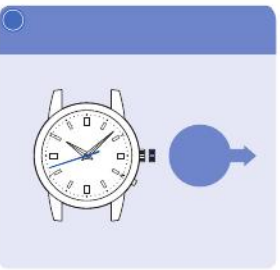
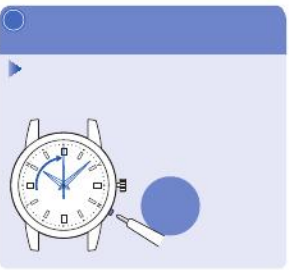

One minute after the hour and minute hands stop after the operation ③, the time difference adjustment mode is finished.

