

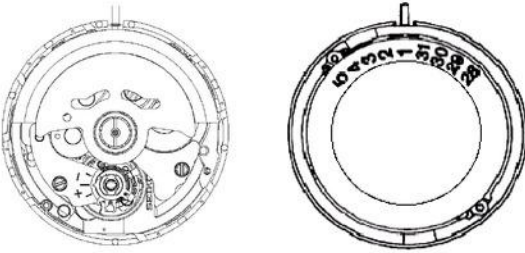
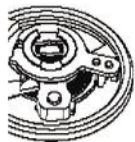

PARTS CATALOGUE/TECHNICAL GUIDE

Cal. 7S25B, 7S35B, 7S55B

[SPECIFICATIONS]

Brand		SEIKO		
Cal. No.		7S25B	7S35B	7S55B
Item				
Movement		 <p style="text-align: center;">(x 1.5)</p>		
Movement size	Outside diameter	Ø 27.4 mm		
	Casing diameter	Ø 27.0 mm		
	Height	4.9 mm		
Time indication		● 3 hands (hour, minute and second hands)		
Vibration per hour		21,600 Hz/hour (6 beats per second)		
Additional function		<ul style="list-style-type: none"> ● Automatic winding ● Date calendar ● Date correction function 		
Number of jewels		7S25B :21 jewels 7S35B, 7S55B :23 jewels		
The difference between A Cal. and B Cal. * Cal.7S watches are changed from caliber "A" to caliber "B" in October 2006 production. According to the change, we would like you to pay attention to the design of the balance staff when repairing those watches.		7S25A/ 7S35A/ 7S55A	7S25B/ 7S35B/ 7S55B	
				
		Refer to "PARTS CATALOGUE/ TECHNICAL GUIDE Cal. 7S25A,7S35A,7S55A."	Refer to "PARTS CATALOGUE/ TECHNICAL GUIDE Cal. 7S25B,7S35B,7S55B."	

SEIKO WATCH CORPORATION



ManualLib.com

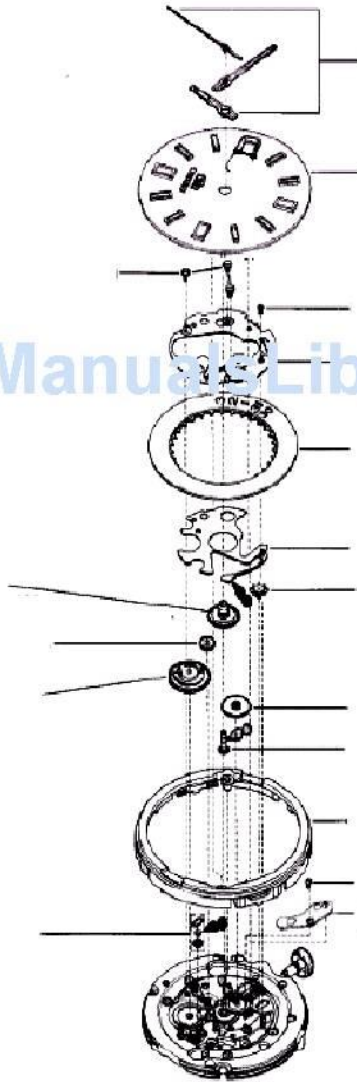



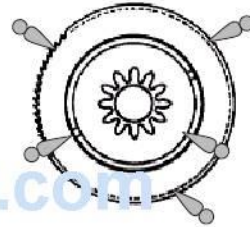
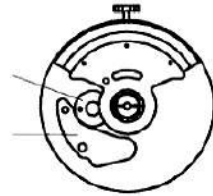

ManualsLib.com

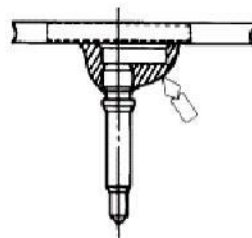
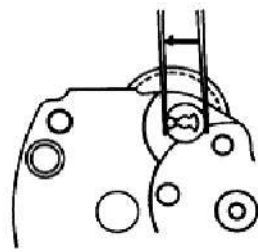
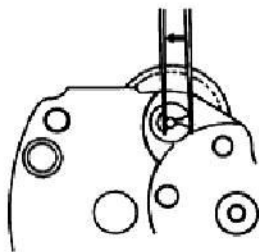

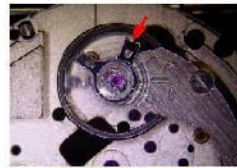
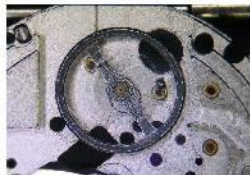
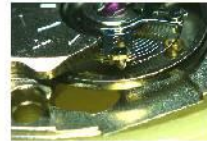
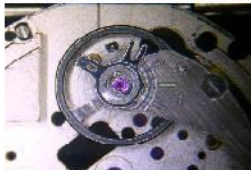
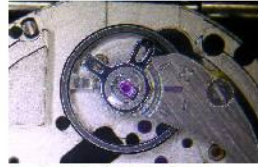
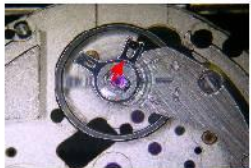
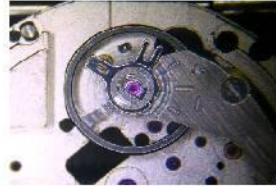
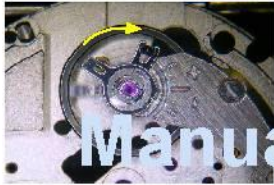
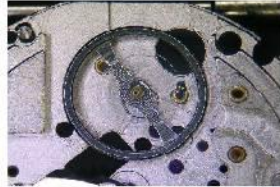
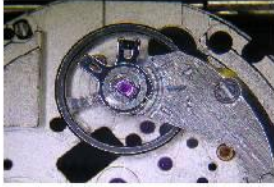

ManualsLib.com

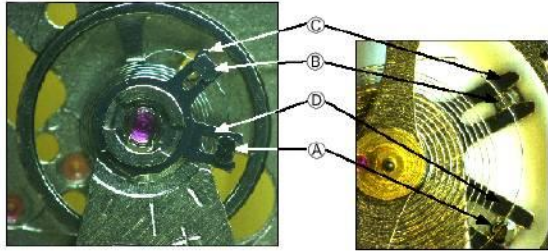

ManualsLib.com

