

SEIKO
ManualsLib.com

I N S T R U C T I O N S



ManualsLib.com



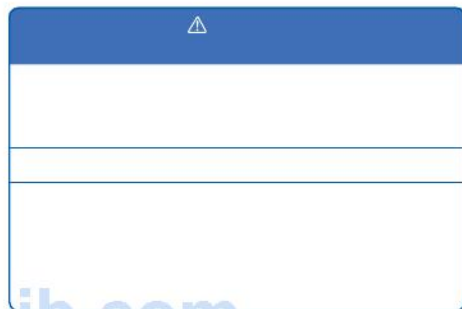
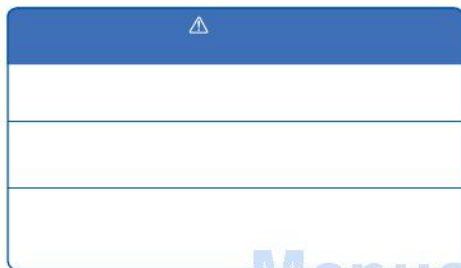

ManualsLib.com

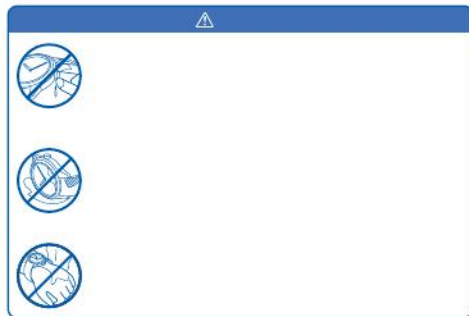



 Too Hot
Use Under 50 °C

EN 10 08

 Too Cold
Use Over -5 °C

ManualsLib.com



ManualsLib.com

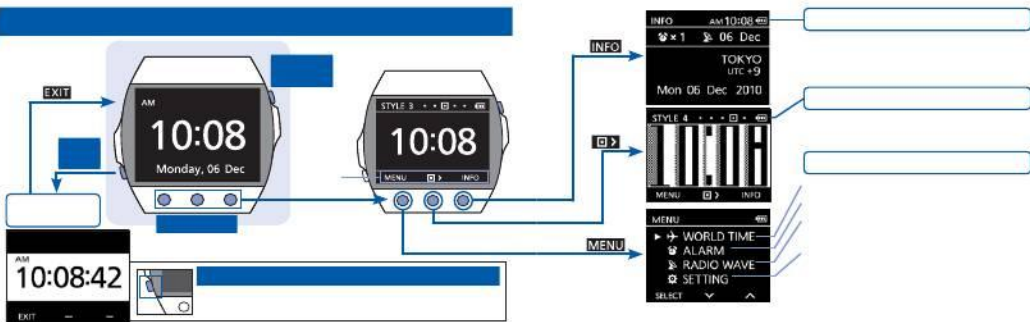



ManualsLib.com

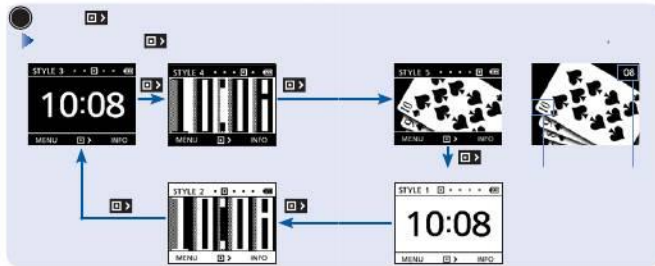



ManualsLib.com





ManualsLib.com



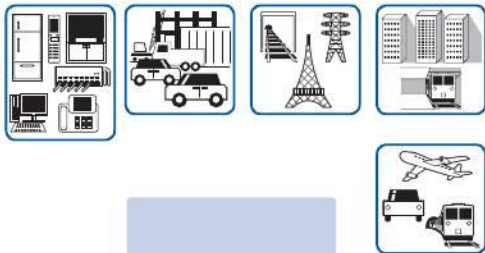

ManualsLib.com

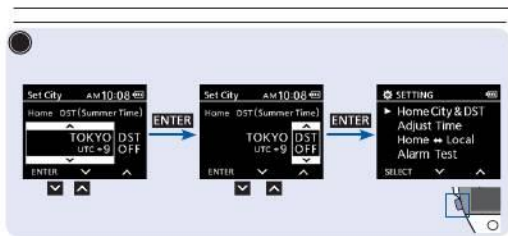
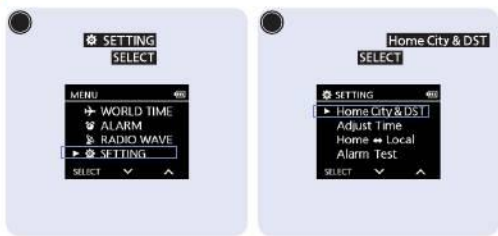
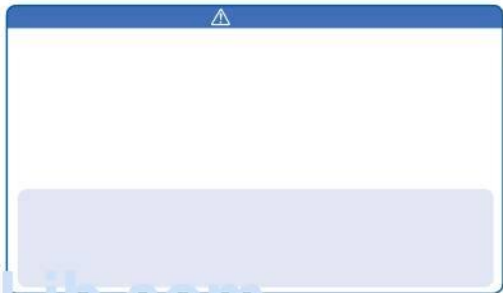

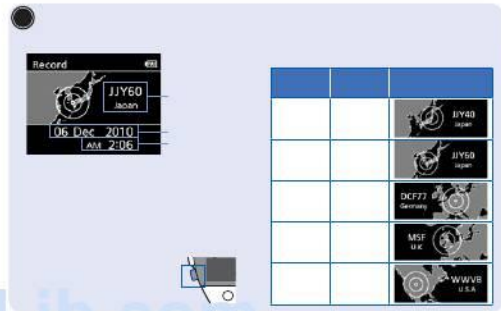

ManualsLib.com

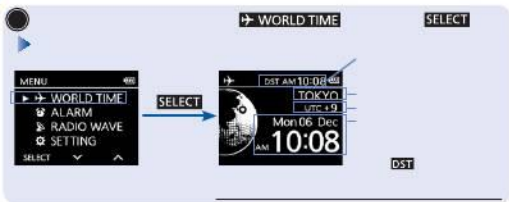

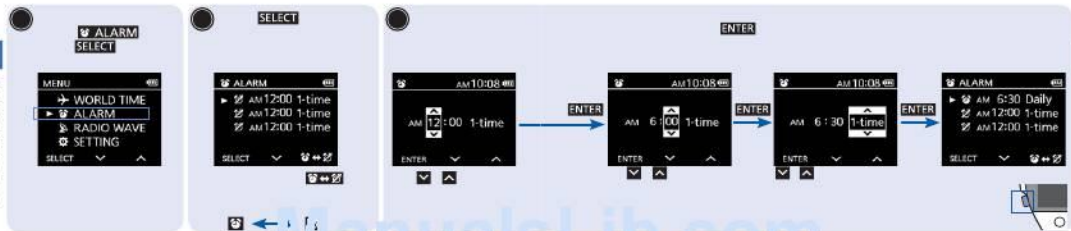

ManualsLib.com



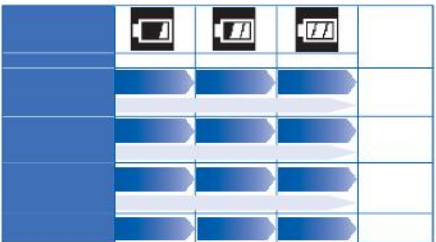

ManualsLib.com



	POWER SAVE	SLEEP

ManualsLib.com

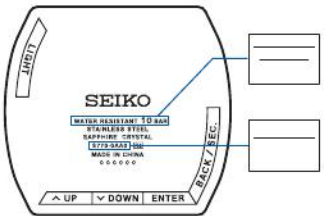

ManualsLib.com



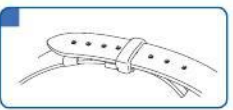
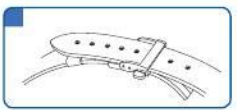
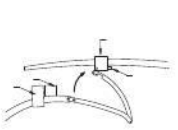
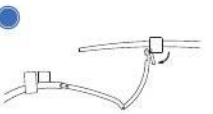

ManualsLib.com

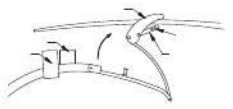
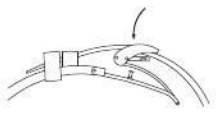
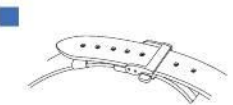
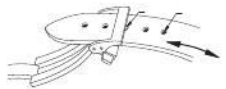
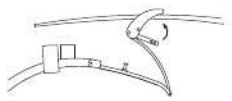
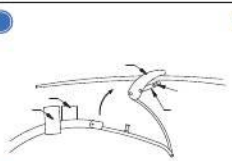
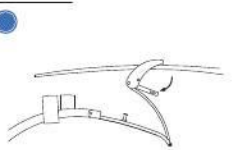

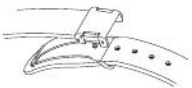
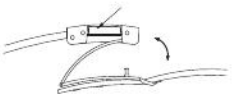
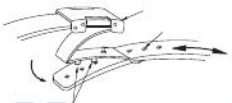
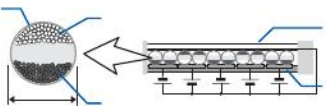

ManualsLib.com



ManualsLib.com



SELECT

RADIO WAVE



Receive

SELECT





ManualsLib.com

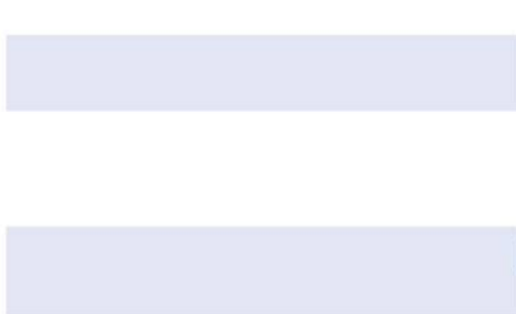

How to manually set the time and date (Year, month and date)

When you use the watch continuously outside the reception range or in a place or region where the watch cannot receive radio waves, manually set the time and date.
→ "Radio wave reception range" P112

When you start using the watch in a radio wave receivable environment, let the watch receive radio waves so that it can set the time and date.
→ Automatic reception and manual reception P111

- When the watch sets the time and date after it successfully received radio waves, you do not have to manually adjust the time and date.
- Even if the watch cannot receive radio waves, its accuracy is kept by the quartz movement with monthly accuracy within 15 seconds.
- If the watch receives radio waves after the time and date were manually set, it will indicate the time and date obtained by the reception.

■ Setting the time

- ① In the Menu Display, select **SETTING** and press **SELECT**.



To show the Menu Display
→ How to change the modes and displays P104

- ② In the Miscellaneous Setting Mode, select **Adjust Time** and press **SELECT**.



If you only want to set the date, go to step ③ on P166.

- ③ Press **SELECT** to select the time indication format.



Continued on the next page

④ Setting the hour and minute

With each pressing of **ENTER**, the selectable segment will be activated.



Press **▼** or **▲** to set the hour.

Press **▼** or **▲** to set the minute.

Press **▼** or **▲** to reset the figures to "00."

- If you press **ENTER** or the **BACK** button without pressing **▼** or **▲**, the watch returns to the step ③.
- If you press the **BACK** button after pressing **▼** or **▲**, the watch immediately starts moving from 0 seconds. This action will have the same effect as step ③, when the watch starts moving from 0 second.

⑤ Setting the second



Press **START** simultaneously with a time signal.

You can see the second counting.

To continue to the date setting, go to the next page.

To return to the time display, hold down the **BACK** button.

Hold down

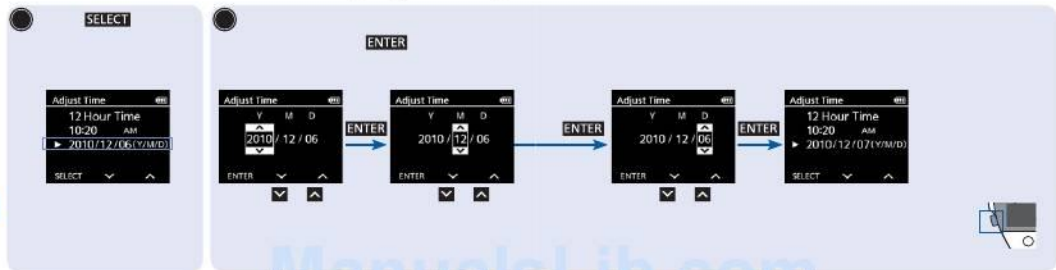

ManualsLib.com

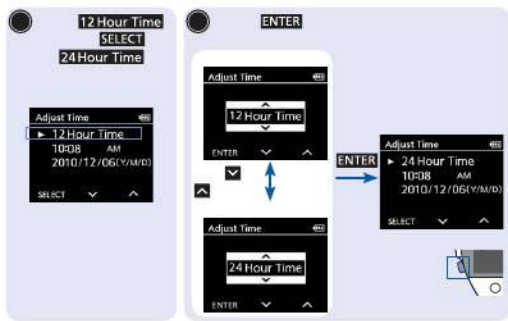

Troubleshooting

	POWER SAVE	SLEEP	AM10:08 ⚠ Too Cold Use Over 5°C		
				🔋	⚠ Too Hot Use Under 50°C

Troubleshooting

ManualsLib.com

Troubleshooting

Troubleshooting

Troubleshooting

Troubleshooting

ManualsLib.com

Troubleshooting

Troubleshooting

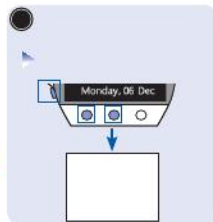

ManualsLib.com