

# CITIZEN®

**Model No.CA0\*\*\* / Cal.No.B61\***

- INSTRUCTION MANUAL
- BETRIEBSANLEITUNG
- MANUEL D'INSTRUCTION
- MANUAL DE INSTRUCCIONES
- MANUALE DI FUNZIONAMENTO
- MANUAL DE INSTRUÇÕES
- 説明書
- 说明书



***Eco-Drive***

CTZ-B8143

Thank you for purchasing a CITIZEN watch. To ensure correct use, please read these instructions carefully. Please confirm that the CITIZEN International Guarantee Card is included for your possible claim.

Vielen Dank für den Kauf dieser CITIZEN Uhr. Bitte lesen Sie diese Anleitung durch, um mit den Funktionen dieser Uhr vertraut zu werden. Überprüfen Sie bitte in Ihrem eigenen Interesse, ob der Uhr die internationale CITIZEN Garantiekarte beigelegt ist.

Nous vous remercions d'avoir porté votre choix sur une montre CITIZEN. Pour assurer une utilisation correcte, veuillez lire ces instructions attentivement. Veuillez vous assurer que la carte de garantie internationale CITIZEN est fournie pour toute réclamation éventuelle.

Muchas gracias por la compra de este reloj CITIZEN. Para asegurar un uso correcto, lea detenidamente estas instrucciones. Verifique de que la tarjeta de Garantía Internacional de CITIZEN le sea suministrada con el reloj en el momento de la compra, de esta manera, podrá reclamar servicios de acuerdo con los términos de la garantía.

Grazie per aver scelto un orologio CITIZEN. Per la sicurezza di un uso corretto, si prega di leggere attentamente le istruzioni. Inoltre abbiate la cortesia di assicurarvi che la carta di garanzia internazionale CITIZEN sia inclusa in caso di un eventuale reclamo.

Muito obrigado por adquirir um relógio CITIZEN. Para garantir uma utilização correta, por favor leia estas instruções atentamente. Confirme também se o Cartão Internacional de Garantia da CITIZEN acompanha o relógio. Ele será necessário no caso de uma possível reclamação.

承蒙購買CITIZEN錶。為確保正確的使用，敬請仔細閱讀此使用指南。請確認同附的CITIZEN國際保證卡，以享受免費修理之權利。

承蒙惠購CITIZEN表，謹致謝意。為確保正確使用，敬請仔細閱讀此使用指南，請確認隨附的CITIZEN國際保證卡，以享受免費修理的權利。

English

Deutsch

Français

Español

Italiano

Portugues



繁體中文

簡體中文

## Safety Precautions: Observe at All Times

The following provides an explanation of those matters that should be observed at all times to prevent injury to the wearer or other persons as well as damage to property before they occur.

- The degree of injury or damage resulting from incorrect use while ignoring the indicated matters is classified and explained using the following markings.

|  |   |
|--|---|
|  <b>WARNING</b> | This marking indicates matters for which there is the risk of death or serious injury.        |
|  <b>CAUTION</b> | This marking indicates matters for which there is the risk of injury or property damage only. |

- The types of matters to be observed are classified and explained using the following mark (the following indicates two examples of icons).



This mark indicates that caution or attention is required.



This mark indicates prohibited matters.



\* The illustrations shown in this manual may differ from the actual watch you have purchased.

## Product Features

This watch includes a rechargeable cell. This cell is fed electricity by a solar cell in which light energy is converted to electrical energy.

### ◆ Eco-Drive

The watch operates by converting sunlight into electrical energy, which is stored in a rechargeable battery. The rechargeable battery is a clean energy source that does not contain mercury or other harmful substances. When the watch is fully charged, it will operate continuously for approximately seven months.

### ◆ Quick Start Function

A watch that has stopped due to an insufficiently charged cell will start operating immediately when exposed to light.

### ◆ Insufficient Charge Warning Function

Special hand movement to let you know when the reserve energy is getting low.

### ◆ Overcharge Prevention Function

This protects the rechargeable cell from overcharging. This provides worry free enjoyment, not matter how much light your watch is subjected to.

### ◆ Chronograph

This feature enables elapsed time measurement (stopwatch.) You can measure time in activities such as walking, jogging, bicycle riding, etc.

# Contents

- Troubleshooting ..... 1
- Component identification ..... 2
- Recharging your watch ..... 4
- Setting the Time ..... 8
- Setting the Date ..... 10
- Using the Chronograph..... 12
- Precautions ..... 16
- Specifications..... 26

# Troubleshooting

- The second hand is moving at two-second intervals. → P. 6
- The chronograph second hand does not return to reference position even when reset. → P.14
- The watch does not return to normal one-second interval movement even when charged.
- The watch does not operate even when charged.
- The watch stops immediately even when charged.
- The chronograph minute hand does not return to reference position even when reset.



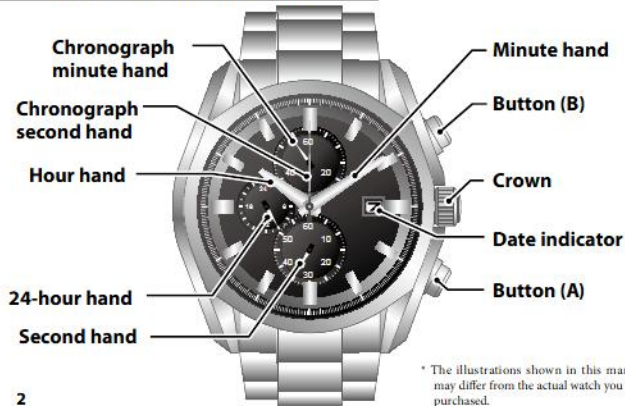

**Submit your watch to your nearest Authorized Citizen Service Center.**

## Component identification



## How to use the screw down crown and screw down push button

Some models feature a screw down crown and/or screw down push button. Locking the crown and/or button prevents accidental operation. These must be unlocked prior to using certain features of your watch such as setting the time or date.

|                               | Unlock  | Lock   |
|-------------------------------|---|--|
| <b>Screw down crown</b>       | <br>Rotate the crown counterclockwise (left) until it releases from the case.    | <br>Rotate the crown clockwise (right) while pushing it in, and tighten firmly. |
| <b>Screw down push button</b> | <br>Rotate the locking screw counterclockwise (left), and loosen until it stops. | <br>Rotate the locking screw clockwise (right), and tighten firmly.             |

\* Unlocking is not required when a standard crown and button are equipped.

## Recharging your watch

This watch uses a built-in rechargeable cell to store electrical energy. Charge the watch by exposing the dial to light such as direct sunlight or fluorescent lamps.

### ◆ To ensure optimal operation, be sure to perform the following.

- Charge the watch in direct sunlight (outdoors) once a month for 5 to 6 hours.
- When you take your watch off, be sure to place it in a location where the dial can receive light. An ideal location might be a window sill where it can receive direct sunlight.



Wearing clothes that cover the watch may inhibit sufficient light from reaching the watch face, resulting in insufficient charging.

Avoid charging the watch under high temperature conditions (approximately 60°C/140°F or more).

### If the reserve power becomes insufficient (Insufficient Charge Warning Function)

When the rechargeable cell charge reaches a low power state, the Insufficient Charge Warning Function engages. This causes the second hand to move in two-second intervals (two-second interval movement). Be sure to immediately fully charge your timepiece by exposing it to light.

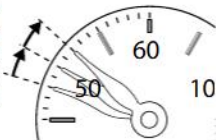

- Two-second interval movement continues for some seven days until the watch stops completely due to battery depletion.

#### Caution

When the watch is operating in the two-second interval mode (low power/insufficient charge warning), you cannot operate chronograph.

### ◆ Charging time by environment

Below are the approximate times needed for charging when exposing the watch dial to light continuously. Please use this table as a reference only.

| Environment  | Illuminance (Lx)  | Charging time to work for one day | Charging time to start working normally when the rechargeable cell is empty |
|--|-------------------|-----------------------------------|---|
| Under direct sunlight or cloudy weather (not through a window) | 10,000 to 100,000 | 2 to 11 minutes                   | 1.5 hours to 7 hours  |
| 20 cm under a fluorescent lamp (30 W)                          | 3,000             | 35 minutes                        | 25 hours  |
| Interior lighting  | 500               | 3.5 hours                         | 150 hours   |

- This watch will run for approximately 7 months from a **full charge** without further exposure to light.

## Setting the Time

1

Pull the crown out to position 2.

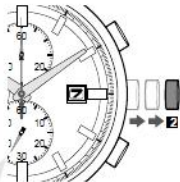

Pull out the crown just as the second hand is at the reference position in order to accurately align to the second.

2

Rotate the crown to set the time.



The 24-hour hand (located at the 9:00 subdial) moves in relation to the hour hand. Determine whether it is a.m. or p.m. by observing the 24-hour hand.

Move the minute hand ahead of the correct time by 5 "minutes" and then return the hand to the correct "minutes". This will minimize the effect of gear play and will provide more accurate hand movement.

3

Press the crown back into its normal position.

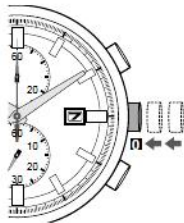

Be sure to secure if the watch has a screw down crown. Water may enter your watch.

## Setting the Date

- 1** Pull the crown out to position 1.

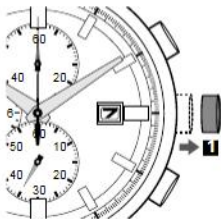

- 2** Rotate the crown counter-clockwise to set the date. The date will not change when the crown is rotated clockwise.



The date does not change when you rotate the crown to the right.

- 3** Press the crown back into its normal position.

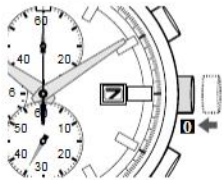

Be sure to secure if the watch has a screw down crown. Water may enter your watch.

The date must be manually adjusted for months shorter than 31-days. You will need to adjust the date at the start of March, May, July, October and December.

Do not adjust the date between 9 p.m. and 1 a.m. If you change the date during this time, the date may not change the following day.

## Using the Chronograph

The chronograph can measure up to 60 minutes in 0.2-second units.

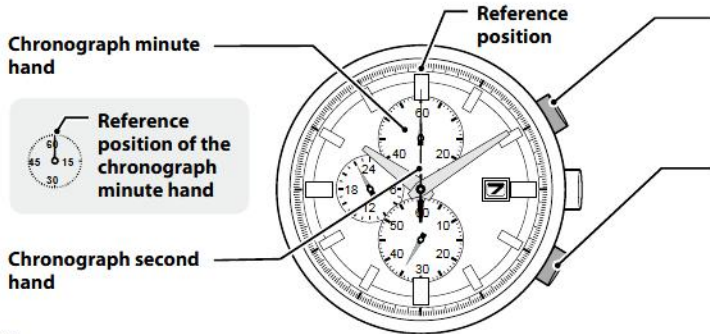

Chronograph minute hand

Reference position of the chronograph minute hand

Chronograph second hand

Reference position

### Caution

The chronograph minute/second hands may become misaligned if the watch is subjected to a strong knock. If the position cannot be corrected by using the reset procedures outlined on pages 12-13, please contact your nearest Authorized Service Center.

### Time measurement start/stop

- 1 To start the chronograph, press and release the upper right button (B) to commence time measurement.
- 2 To stop the chronograph, press and release the upper right button (B) again.
- 3 To recommence timing from the stopped position, press and release the upper right button (B) again.

### Reset

To reset the chronograph after stopping time measurement, press and release the lower right button (A).

Pressing and releasing the lower right button (A) during chronograph operation will cause timing to stop and the chronograph to reset.

The chronograph does not function if the crown is pulled out to position 2. The chronograph resets if the crown is pulled out to position 2 during measurement.

◆ **When the chronograph second hand does not return to the reference position**

If the chronograph second hand does not return to reference position even when reset, perform the following procedures to align the chronograph second hand with the reference position.

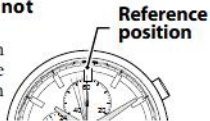

Time is stopped while aligning with the reference position. Set the time after aligning.

**1** Set the watch to correct the reference position

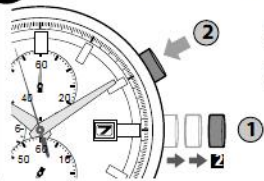

- 1** Pull the crown out to position 2.
- 2** Press and hold the upper right button (B) for 3 seconds or more. The watch is now set to correct the reference position.

**2** Correct the position of the second hand

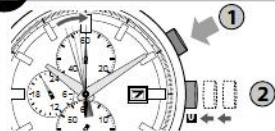

- 1** Press and release the upper right button (B) to adjust the position of the chronograph second hand.

- **Press once** → Second hand moves ahead at one-second intervals.
- **Press and hold down** → Second hand advances rapidly.

If the second hand does not move even when the upper right button (B) is pressed, perform Step **1** the page on the left.

- 2** Press the crown back into its normal position.

**3** Reset the minute hand



Press and release the lower right button (A) to adjust the position of the chronograph minute hand.





The chronograph minute hand moves together with the second hand when correcting the second hand. Reset the minute hand.

Be sure to secure if the watch has a screw down crown and/or screw down push button. Water may enter your watch.

## Precautions

### **WARNING** Water-resistance performance

- There are several types of water-resistant watches, as shown in the following table. The unit “bar” is roughly equal to 1 atmosphere.
- For correct use within the design limits of the watch, confirm the level of water-resistance of your watch, as indicated on the dial and case, and consult the table.

| Indication                         |   | Specifications                       | Examples of use   |   |   |   |   |
|------------------------------------|---|--------------------------------------|---|---|---|---|---|
| Dial                               | Case (case back)                                    |                                      |  |  |  |  |  |
| WATER RESIST or no indication      | WATER RESIST(ANT)                                   | Water-resistant to 3 atmospheres     | <b>OK</b>   | <b>NO</b>   | <b>NO</b>   | <b>NO</b>   | <b>NO</b>   |
| WR 50 or WATER RESIST 50           | WATER RESIST(ANT) 5 bar or WATER RESIST(ANT)        | Water-resistant to 5 atmospheres     | <b>OK</b>   | <b>OK</b>   | <b>NO</b>   | <b>NO</b>   | <b>NO</b>   |
| WR 100/200 or WATER RESIST 100/200 | WATER RESIST(ANT) 10bar/20 bar or WATER RESIST(ANT) | Water-resistant to 10/20 atmospheres | <b>OK</b>   | <b>OK</b>   | <b>OK</b>   | <b>NO</b>   | <b>NO</b>   |

\* WATER RESIST(ANT) xx bar may also be indicated as W.R. xx bar.

## **WARNING** Water-resistance performance

- Water-resistance for daily use (to 3 atmospheres): This type of watch is water-resistant to minor exposure to water. For example, you may wear the watch while washing your face; however, it is not designed for use underwater.
- Upgraded water-resistance for daily use (to 5 atmospheres): This type of watch is water-resistant to moderate exposure to water. You may wear the watch while swimming; however, it is not designed for use while skin diving.
- Upgraded water-resistance for daily use (to 10/20 atmospheres): This type of watch may be used for skin diving; however, it is not designed for scuba or saturated diving using helium gas.

## **CAUTION**

- Be sure to use the watch with the crown pressed in (normal position). If your watch has a screw down crown, be sure to tighten the crown completely.
- Do NOT operate the crown or button with wet fingers or when the watch is wet. Water may enter the watch and compromise water-resistance.
- If the watch is used in seawater, rinse with fresh water afterward and wipe with a dry cloth.
- If moisture has entered the watch, or if the inside of the crystal is fogged up and does not become clear within a day, immediately take the watch to your dealer or Citizen Service Center for repair. Leaving the watch in such a state will allow corrosion to form inside.
- If seawater enters the watch, place the watch in a box or plastic bag and immediately take it in for repair. Otherwise, pressure inside the watch will increase, and parts (crystal, crown, buttons, etc.) may come off.

## CAUTION Keep your watch clean

- Leaving dust and dirt deposited between the case and crown may result in difficulty in pulling the crown out. Rotate the crown while in its normal position, from time to time, to loosen dust and dirt and then brush it off.
- Dust and dirt tend to be deposited in gaps in the back of the case or band. Deposited dust and dirt may cause corrosion and soil your clothing. Clean the watch occasionally.

### Cleaning the Watch

- Use a soft cloth to wipe off dirt, perspiration and water from the case and crystal.
- Use a soft, dry cloth to wipe off perspiration and dirt from the leather band.
- To clean a metal, plastic, or rubber watchband, wash away dirt with mild soap and water. Use a soft brush to remove dust and dirt jammed in the gaps in the metal band. If your watch is not water-resistant, take it to your dealer.

**Note:** Avoid using solvents (thinner, benzine, etc.), as they may damage the finish.

## CAUTION Operating environment

- Use the watch within the operating-temperature range specified in the instruction manual. Using the watch where temperatures are outside the specified range, may result in deterioration of functions or even stoppage of the watch.
- Do NOT use the watch in places where it is exposed to high temperature, such as in a sauna. Doing so may result in a skin burn.
- Do NOT leave the watch in a place where it is exposed to high temperature, such as the glove compartment or dash-board of a car. Doing so may result in deterioration of the watch, such as deformation of plastic parts.
- Do NOT place the watch close to a magnet. Timekeeping will become inaccurate if you place the watch close to magnetic health equipment such as a magnetic necklace or a magnetic latch of a refrigerator door or handbag clasp or the earphone of a mobile phone. If this has occurred, move the watch away from the magnet and reset the time.
- Do NOT place the watch close to household appliances that generate static electricity. Timekeeping may become inaccurate if the watch is exposed to strong static electricity, such as is emitted from a TV screen.

- Do NOT subject the watch to a strong shock such as dropping it onto a hard floor.
- Avoid using the watch in an environment where it may be exposed to chemicals or corrosive gases. If solvents, such as thinner and benzine, or substances containing such solvents come in contact with the watch, discoloration, melting, cracking, etc. may result. If the watch comes in contact with mercury used in thermometers, the case, band or other parts may become discolored.

## **Periodical inspections**

Your watch needs inspection once in every two or three years for safety and long use. To keep your watch water-resistant, the packing needs to be replaced regularly. Other parts need to be inspected and replaced if necessary. Ask for Citizen genuine parts upon replacement.

**⚠ WARNING Handling the rechargeable cell**

- Do not remove the rechargeable cell from the watch yourself. If you must remove the cell, store it out of reach of children to avoid accidental ingestion.
- If the rechargeable cell is ingested, consult a doctor immediately.
- Do not throw away with regular trash. Please follow your local government disposal regulations to prevent the risk of fire or environmental contaminations.

**⚠ WARNING Do not use anything other than the specified rechargeable cell**

- The watch will not operate if incorrect battery types are inserted.
- Never use a regular silver battery. The battery could overcharge during the charging process and burst, causing damage to the watch or injuries to the wearer.

**⚠ CAUTION Charging precautions**

- Do not charge the watch in a high-temperature environment (about 60°C/140°F or more). Overheating while charging can cause the watch exterior to become discolored, the watch to deform or the movement to be damaged.  
Example)
  - Charging close to incandescent lighting, halogen lamps, or other lighting sources that easily become hot.
  - Charging on surfaces that can easily become hot, such as a car dashboard.
- When charging with incandescent lighting, halogen lamps, or other lighting sources that easily become hot, place the watch at least 50 cm (20 in.) away from the source to avoid overheating.

## Specifications

|  |   |
|--|---|
| <b>Mvmnt. Cal. No.:</b>                  | B61 *   |
| <b>Type</b>                              | Analog solar-powered watch  |
| <b>Timekeeping accuracy</b>              | Within +/-15 seconds per month when worn at normal operating temperatures (+5°C / 41°F and +35°C / 95°F)  |
| <b>Operational temperature range</b>     | -10°C / 14°F to +60°C / 140°F   |
| <b>Display functions</b>                 | Time: Hour, minute, second, and 24-hour<br>Calendar: Date (does not automatically adjust for months shorter than 31-days)   |
| <b>Additional functions</b>              | Chronograph (measures up to 60 minutes in 0.2-second units), Insufficient Charge Warning Function, Overcharge Prevention Function, Quick Start Function)            |
| <b>Maximum run time from full charge</b> | Fully charged to fully discharged:<br>Approximately seven months<br>Power reserve upon Insufficient Charge Warning Function engagement:<br>Approximately seven days |
| <b>Battery</b>                           | Rechargeable cell 1pcs  |