

SEIKO
SINCE 1881

SEIKO WATCH CORPORATION
Copyright©2021 by SEIKO WATCH CORPORATION

Printed in Japan

SEIKO



العربية

简体中文 繁體中文 한국어 ไทย





HOW TO USE





Names of the parts and their functions

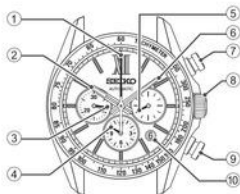

- ① Center stop watch seconds hand
- ② Hour hand
- ③ Stop watch minute hand (Measures up to 30 minutes)
- ④ Stop watch hour hand (Measures up to 12 hours) (BR48 only)
- ⑤ Small seconds hand
- ⑥ Minute hand
- ⑦ Button A
Start/stop of the stopwatch
- ⑧ Crown
- Normal position (not locked): Wind up the watch (hand-wound)
 - First click position: Time difference adjustment/Date setting
 - Second click position: Time setting
- ⑨ Button B
Reset of the stopwatch
- ⑩ Date

* The position and design of the display may vary depending on the model.

EN 8

Crown

There are two types of crowns, a normal crown and a screw down crown. Please check the type of the crown of your watch.

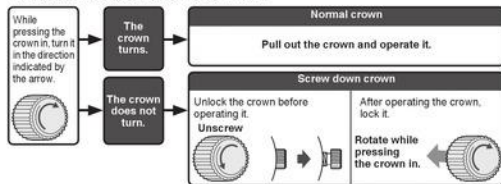

- * By locking the crown by screw, a screw down crown can prevent malfunction and increase water resistance.
- * Be careful not to screw the crown in by force as it may damage the slots of the crown.

EN 9

Screw lock type button

The screw lock type button features a mechanism that can securely lock the button when it is not being operated in order to prevent any operational errors.

- It is necessary to unlock the screw lock type button before operating it.
- Once you have finished operating the button, make sure to relock it.

[To unlock the button]

- Turn the button ring counterclockwise until it stops.
- Now the button can be operated.

[To lock the button]

- Turn the button ring clockwise until it stops.
- Now the button can no longer be operated.

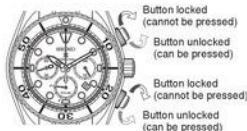

* If the screw or button get dirty, they may not operate properly. "Daily care" -- P.23

* Note that if you turn the button ring more than you need to, the screw lock button may be difficult to return to its original position.

* Do not use the buttons when the watch is wet or when you are underwater.

EN 10

How to wind the mainspring

- This is an automatic mechanical watch with a manual winding mechanism.
- When the watch is worn on the wrist, the mainspring is wound automatically through normal wrist movement. The watch can also be wound up by turning the crown.
- To start the watch after it stops completely, wind it up either by turning the crown or swinging it from side to side until the small seconds hand starts moving. Then, set the time and date before putting the watch on the wrist. To wind up the watch, turn the crown clockwise slowly. The watch cannot be wound by turning the crown counterclockwise. In this way, the watch can be wound up fully. Furthermore, turning the crown further will not break the spring.
- For the watch with screw down crown, please unlock the crown before operating it and be sure to lock the crown after operating it.
- Once the watch is wound up fully, it operates for about 45 hours.
- While the chronograph is used to measure a long period of time, however, the watch will stop operating before 45 hours.

EN 11



■ Date adjustment at the end of the month

It is necessary to adjust the date at the end of February and 30-day months.

Ex.) To adjust the date in the A.M. period on the first day of a month following a 30-day month
The watch displays "31" instead of "1." Pull out the crown to the first click.
Turn the crown counterclockwise to set the date to "1" and then push the crown back in to the normal position.

* For models with screw down crown, please be sure to lock the crown after operating it.



Pull out the crown to the first click

⚠ CAUTION

- Avoid amending the date when the watch is displaying between 8 PM and 2 AM. Doing so may cause damage.

How to use the chronograph

The chronograph can measure up to 30 minutes (for 8R46) or 12 hours (for 8R48).

* "Chronograph" refers to a watch function that measures the elapsed time while indicating the current time.

* Please do not pull out the crown to adjust the time/date while the stopwatch is in operation.

* Before using the stopwatch, be sure to check that the center stopwatch hand is at "0" position. If not, press button B to reset it to "0" position.

* Before using the stopwatch, be sure to check that the watch is wound up sufficiently. If the power reserve indicator indicates less than 10 hours of power reserve, the stopwatch cannot be used.



- ① Center stopwatch seconds hand
- ② Stopwatch minute hand (Measures up to 30 minutes)
- ③ Stopwatch hour hand (Measures up to 12 hours) (8R48 only)
- ④ Button A Start/Stop
- ⑤ Button B Reset of the stopwatch
- ⑥ Tachymeter → P.21

* The position of the tachymeter display may differ depending on the design of the model.

EN 16

EN 17

How to use the stopwatch

• Standard measurement Ex. 5,000 meters running

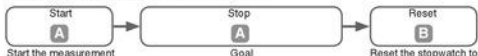

Start the measurement

Goal

Reset the stopwatch to 0 minute 0 second.

Example of measurement.
20 minutes 41 seconds

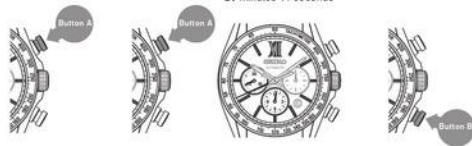

• Accumulated elapsed time measurement Ex. Measuring the time for a soccer match

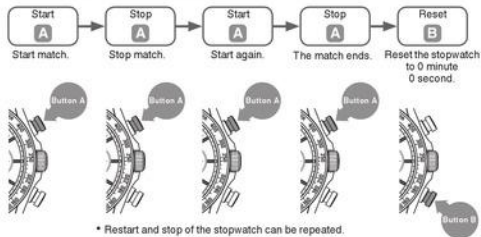

EN 18

EN 19



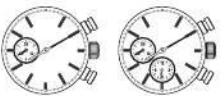

	△
C	
CII	

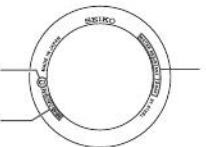

		△
()		



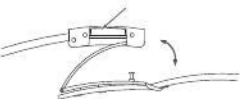
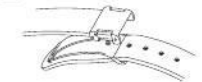
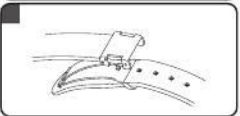
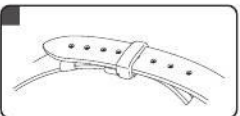
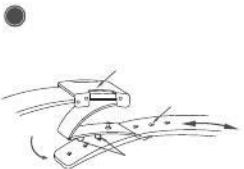
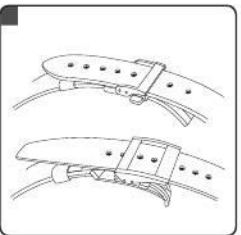
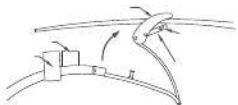
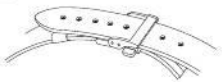
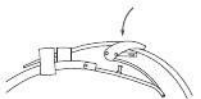
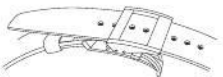
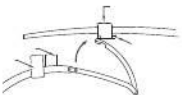
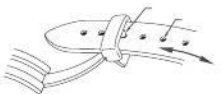

TO PRESERVE THE QUALITY OF YOUR WATCH

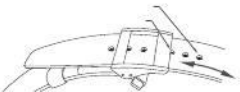
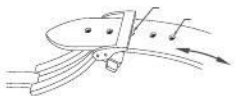
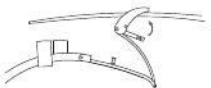

TO PRESERVE THE QUALITY OF YOUR WATCH

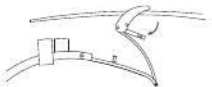
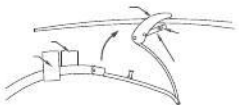
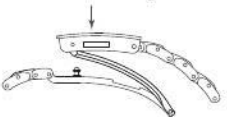
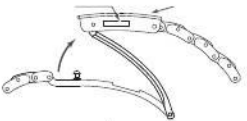

TO PRESERVE THE QUALITY OF YOUR WATCH

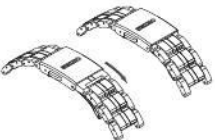

TO PRESERVE THE QUALITY OF YOUR WATCH

TO PRESERVE THE QUALITY OF YOUR WATCH

TO PRESERVE THE QUALITY OF YOUR WATCH

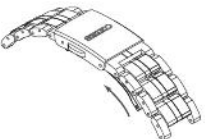
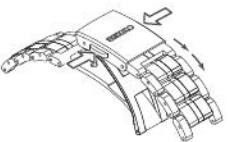

TO PRESERVE THE QUALITY OF YOUR WATCH

TO PRESERVE THE QUALITY OF YOUR WATCH

TO PRESERVE THE QUALITY OF YOUR WATCH

TO PRESERVE THE QUALITY OF YOUR WATCH

TO PRESERVE THE QUALITY OF YOUR WATCH

TO PRESERVE THE QUALITY OF YOUR WATCH