

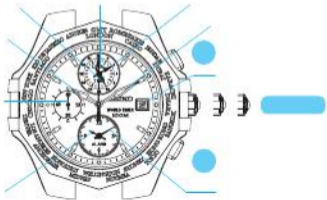

閣下現在已購得有一隻，機件編號為ST82的精工牌指針式石英錶。在使用您的精工牌指針式石英錶以前，務請注意閱讀這本小冊子中的各項說明，並請將手冊妥加保管，以便隨時參考。

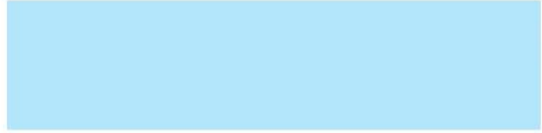

SEIKO

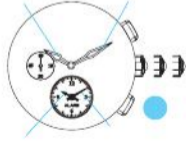
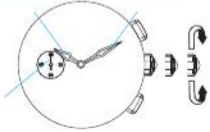

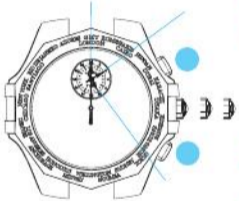







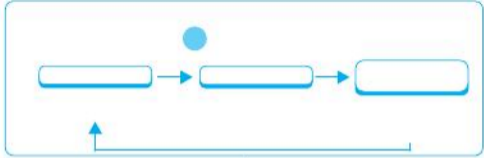

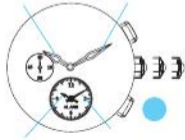
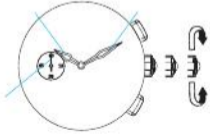

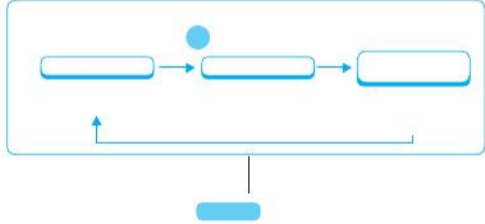
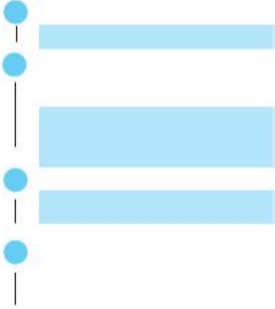
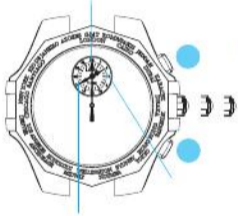

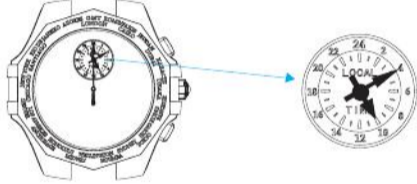
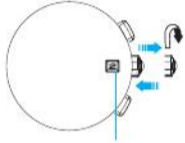

HOW TO USE WORLD TIME FUNCTION

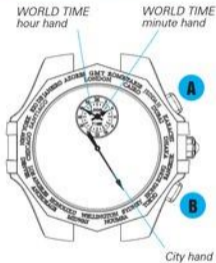

- A** OR **B** Press repeatedly to set the city hand to the city on the bezel whose time you wish to know.
- The city hand turns clockwise or counterclockwise by pressing Button A or B respectively.
 - It moves quickly if the respective button is kept pressed.
- The WORLD TIME hour and minute hands move automatically to indicate the time of the selected city in the 24-hour indication.

The initial adjustment of the WORLD TIME hands should be performed at the same time as the city hand setting. If the WORLD TIME hands are not correctly set, the precise time of the selected city will not be displayed.

- In some products, the arrow marks are printed below the names of cities where daylight saving time is adopted.

To display the local time of one of these cities during the period when daylight saving time is effective, set the city hand to the position where the arrow mark is pointing.



The daylight saving time may change in some areas or countries when they are so decided by the countries concerned.

[Redacted]

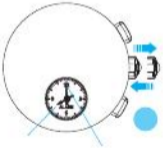

[Redacted]

[Redacted]

—

[Redacted]

[Redacted]

[Redacted]

[Redacted]

[Redacted]



3
Years

