

# CITIZEN®

Model No. AV31 \* \* Catalog No. E27 \*  
ManualsLib.com

- INSTRUCTION MANUAL
- MANUEL D'INSTRUCTIONS
- MANUAL DE INSTRUCCIONES



***Eco-Drive***®

CTZ-A8147

**ManualsLib.com**

[ManualsLib.com](http://ManualsLib.com)

## Component identification

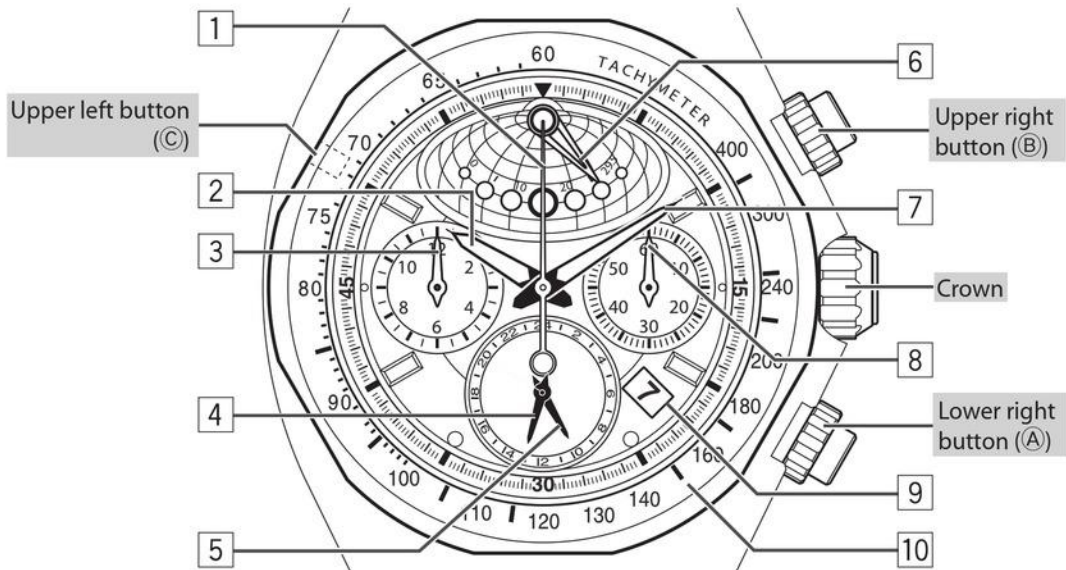



---

**ManualsLib.com**

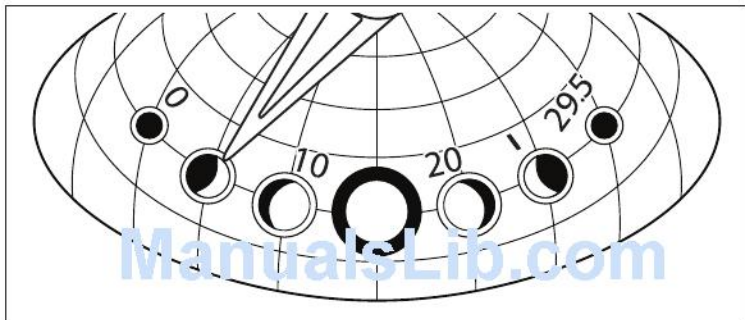

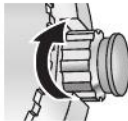

	 <p>ManualsLib.com</p> 	
		

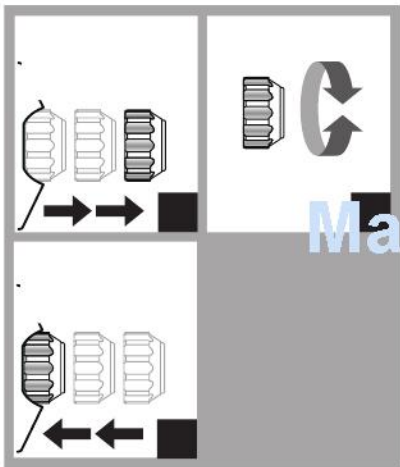

[ManualsLib.com](http://ManualsLib.com)

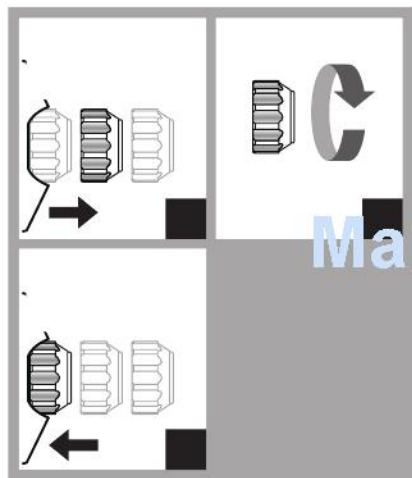

ManualsLib.com



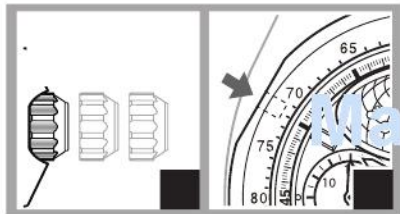



**ManualsLib.com**

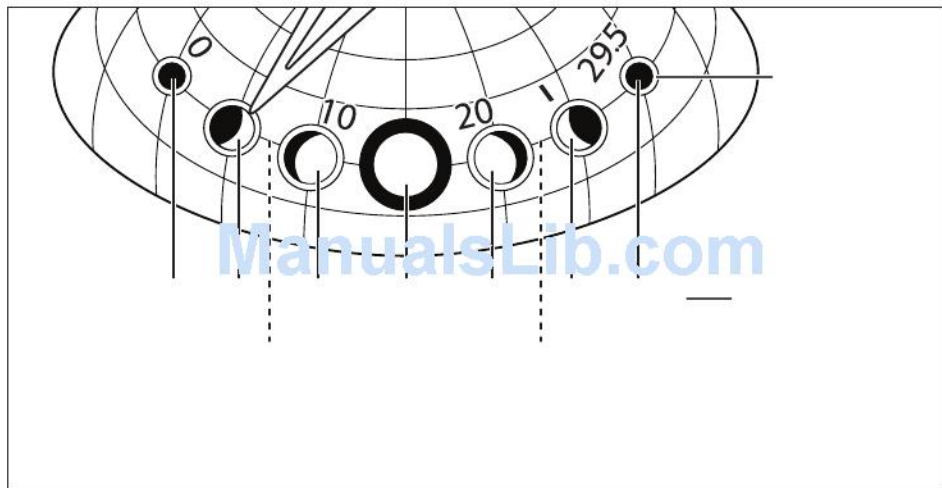

**ManualsLib.com**

# Adjusting the reference (0) position of the moon phase indicator

Adjust the reference (0) position of the moon phase indicator.

- Be sure to reset the chronograph to “0” as shown on page 15 of this instruction prior adjusting the reference (0) position of the moon phase indicator.

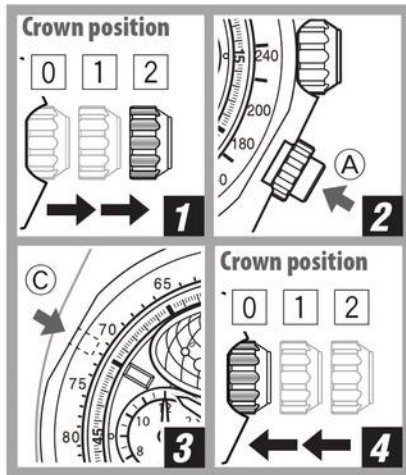

- 1. Pull the crown out to position 2.**
- 2. Press and hold the lower right button (A) for five or more seconds.**

The moon phase indicator moves to indicate the current reference (0) position stored in memory.

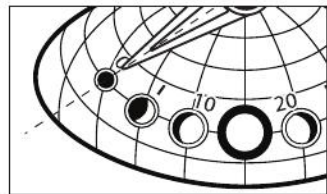

[ManualsLib.com](http://ManualsLib.com)

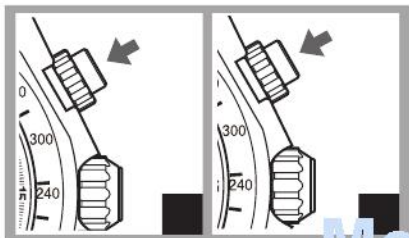

ManualsLib.com



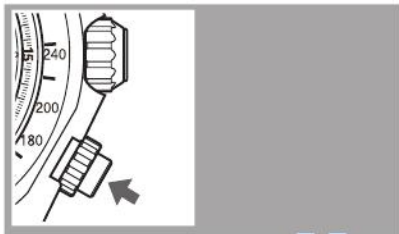

ManualsLib.com



**ManualsLib.com**

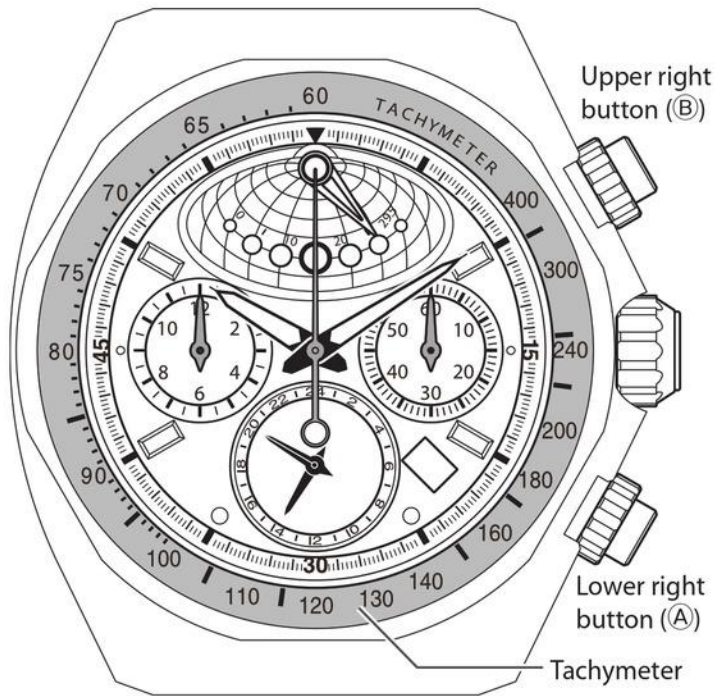

## To measure an average speed

Read the value on the tachymeter after recording a lap time.

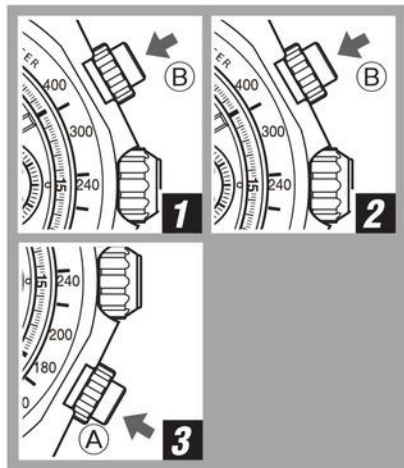

- Ensure that the crown is in position 0.

### 1. Press and release the upper right button (B) to start timing.

The chronograph second hand starts timing.

### 2. Stop timing at the point one kilometer away from the starting point by pressing and releasing the upper right button (B).

The chronograph second hand indicates the approximate average speed on the tachymeter.

### 3. Press and release the lower right button (A) to reset the chronograph.



Ex.: When average is 90 km/h



[ManualsLib.com](http://ManualsLib.com)

ManualsLib.com



	<a href="http://ManualsLib.com">ManualsLib.com</a>		

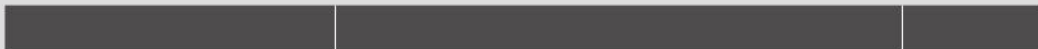
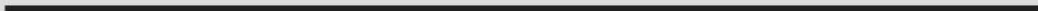

	<a href="http://ManualsLib.com">ManualsLib.com</a>	

--	--	--



<a href="http://ManualsLib.com">ManualsLib.com</a>		

--	--	--

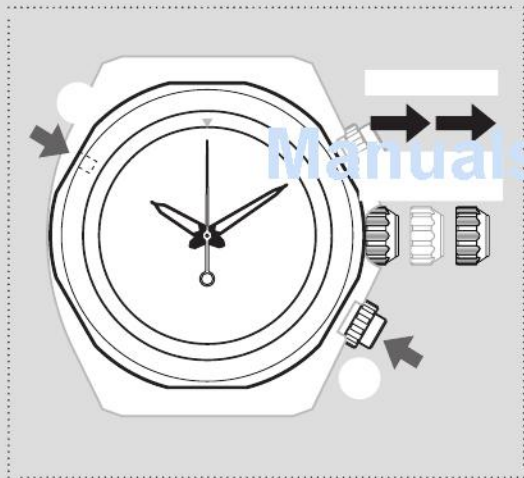





**ManualsLib.com**

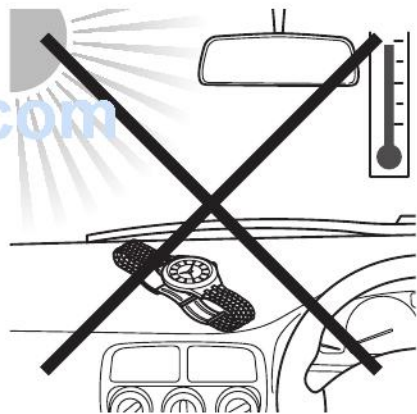

ManualsLib.com



**ManualsLib.com**

**ManualsLib.com**

[ManualsLib.com](http://ManualsLib.com)

ManualsLib.com

[ManualsLib.com](http://ManualsLib.com)

**ManualsLib.com**

A decorative graphic consisting of a thick black L-shaped line at the top left, a vertical black bar below it, and another vertical black bar further down on the left side.

[ManualsLib.com](http://ManualsLib.com)



**ManualsLib.com**



	<a href="http://ManualsLib.com">ManualsLib.com</a>		



**ManualsLib.com**

ManualsLib.com  
**CITIZEN®**