

SEIKO WATCH CORPORATION

Copyright©2023 by SEIKO WATCH CORPORATION

Printed in China

SEIKO



العربية

简体中文 繁體中文 한국어 ไทย



[REDACTED]

[REDACTED]

[REDACTED]

[REDACTED]

[REDACTED]

[REDACTED]

-

-

-

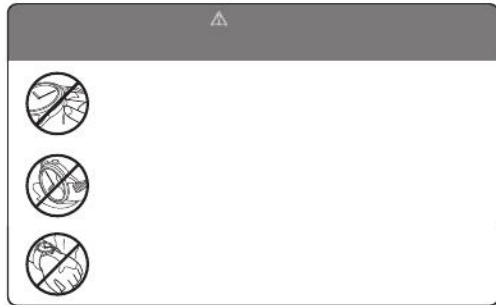
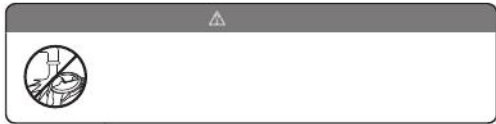
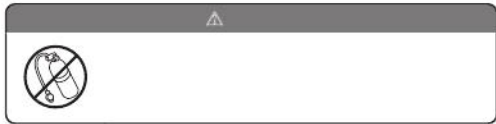
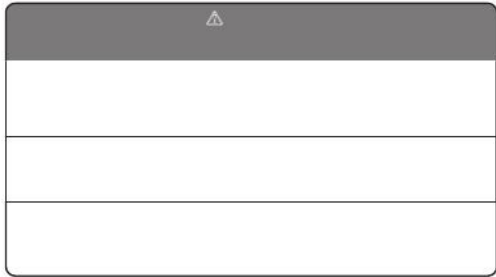

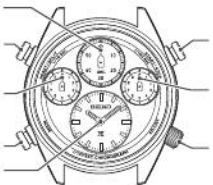
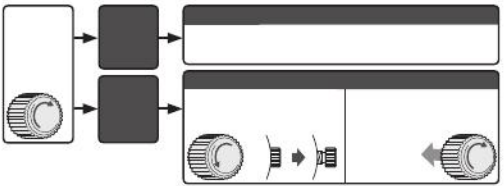

- ①
- ②
- ③
- ④
- ⑤
- ⑥
- ⑦
- ⑧

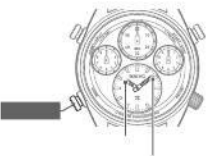
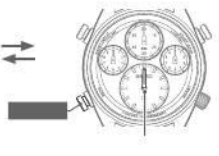

■ Before using the stopwatch

Before using the stopwatch, reset it and check that the stopwatch hands (1/100-second, 1/10-second, second, minute) are stopped at "0 seconds and 0 minutes".

* When the stopwatch hands (1/100-second, 1/10-second, second) point to the 6 o'clock position, the energy is depleted, and the stopwatch will not operate. Charge the stopwatch before use.

"About energy" → P.27

• How to reset the stopwatch

- The stopwatch can be operated when the crown is at the normal position.

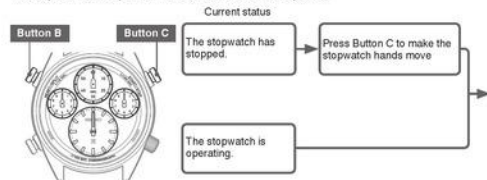

Stopwatch function

The stopwatch can measure up to 60 minutes in 1/100-second increments. After measuring 60 minutes, the stopwatch hands will automatically stop at the 0 minute 0 second position.

■ The names of the parts and functions of the stopwatch

Toggle to the "stopwatch display", "Toggling between displays" → P.12

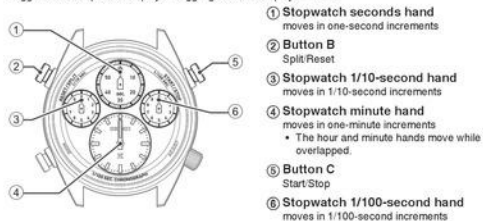

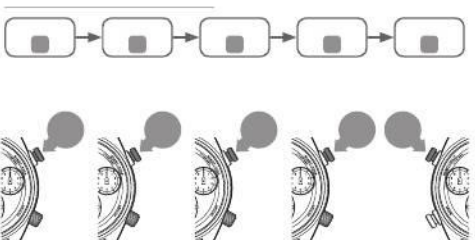
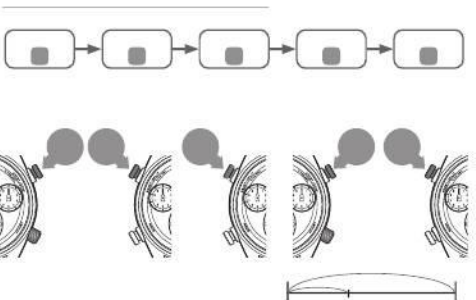
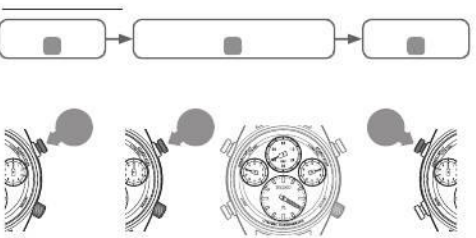

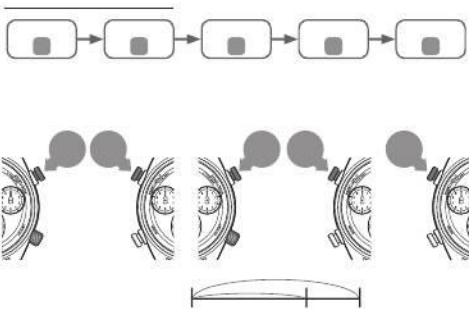



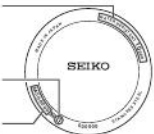

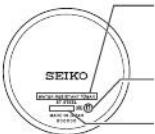



		⚠
()		

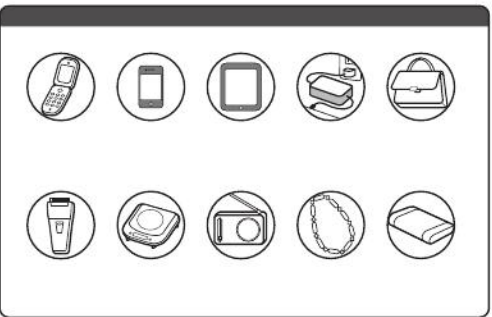

		⚠
CI		
CI		

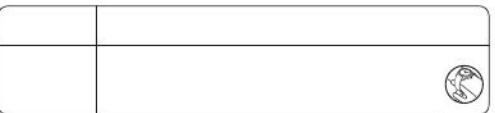
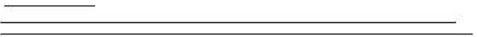
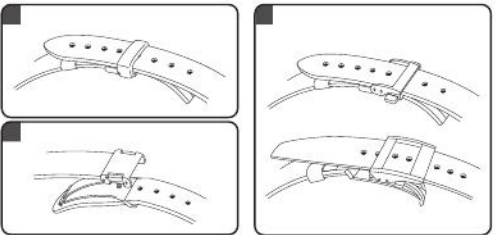
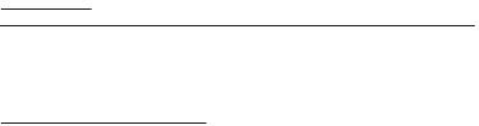

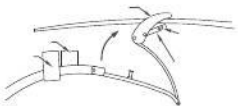
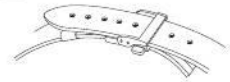
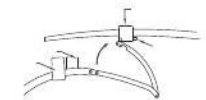
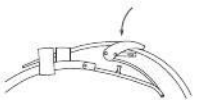
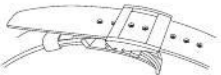
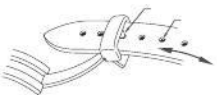
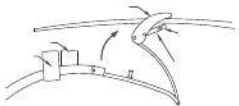
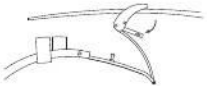
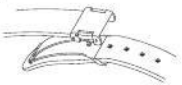
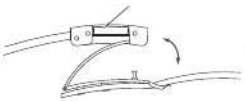
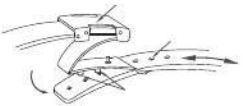

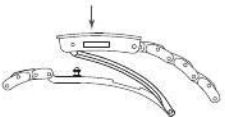
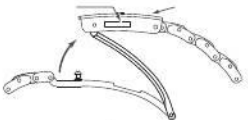
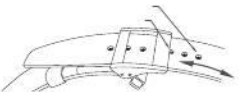
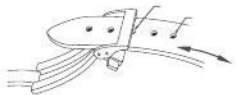
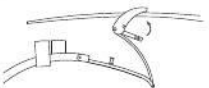
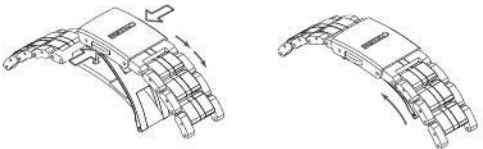
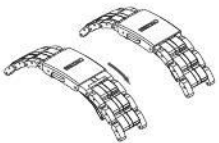

TO PRESERVE THE QUALITY OF YOUR
WATCH

TRO URE. ESHOO TING

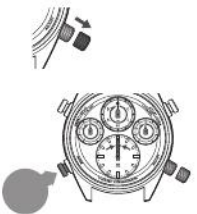

TO PRESERVE THE QUALITY OF YOUR
WATCH

TRO URE. ESHOO TING

5 Set all hands to the 12 o'clock standard position.

Check that each hand is aligned with the 12 o'clock position in the order shown below, and correct the hand positions if they are misaligned.

① Turn the crown to set the hand to the 12 o'clock position

② Press Button A to advance to the next hand position adjustment

* The selected hand moves slightly or completes a full rotation to indicate that it is ready to be aligned.

Repeat ① and ② and set all hands to the 12 o'clock position.

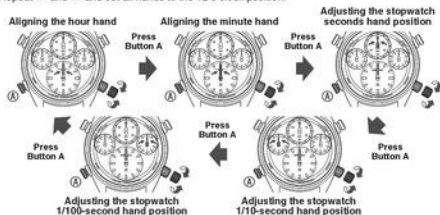

6 Push the crown back in to the normal position.

The watch returns to stopwatch display.

Troubleshooting

Troubles	Possible causes	Solutions	Reference
The watch stops operating.	The energy is depleted. If you wear the watch every day and this occurs, the most likely cause is the watch is hidden by your sleeves or other clothing when you wear it and it is not sufficiently exposed to light.	Sufficiently charge the battery. When you wear the watch, try to make sure that the watch is not hidden by your sleeves or other clothing. Additionally, when you take the watch off, try to place it in a bright place.	P.25
The stopwatch seconds hands (1/100-second, 1/10-second, second) point to the 6 o'clock position.	The energy is low. If you wear the watch every day and this occurs, the most likely cause is the watch is hidden by your sleeves or other clothing when you wear it and it is not sufficiently exposed to light.		
The hands move slowly when toggling between modes.			

Troubles	Possible causes	Solutions	Reference
Stopwatch hands do not point to the 12 o'clock position or do not move after charging a stopped watch.	The internal watch system is unstable. The light is too weak. More time is required to fully charge the watch.	See "Resetting the built-in IC" and follow the procedure. The time taken to charge will differ depending on the light intensity. For details on charging times, see "Guide to charging times". If the hands still fail to resume operation, follow the procedure of "Resetting the built-in IC".	P.57 P.26 P.57
The watch temporarily gains/loses time.	The watch has been left in extremely high or low temperatures for a long time. The watch has been left close to an object with a strong magnetic field.	If the watch returns to room temperature, the accuracy will return to its original state. If it does not return to its original state, contact the retailer from whom the watch was purchased. Correct this condition by moving and keeping the watch away from the magnetic source, and reset the time. If this action does not correct the condition, contact the retailer from whom the watch was purchased.	
	You drop the watch, hit it against a hard surface, or wear it while playing active sports. The watch is exposed to strong vibrations.	If accuracy does not return after setting the time, consult the retailer from whom the watch was purchased.	

