

# Instruction Manual

## LORUS

CAL. VR42 (RZ5 SERIES)  
CAL. VR43 (RZ6 SERIES)

## LORUS

### ■ CHARACTERISTICS

- Solar charging function**
- Power reserve indicator function**
- Energy depletion forewarning function**
- Time/Calendar:** Indicated by the 24-hour, hour, minute and second hands. Date displayed in numerals.
- Stopwatch:** Two Stopwatch hands: second and minute hands. Measures up to 29 minutes and 59 seconds in one-second increments. Split time measurement is available.

### ■ DISPLAY AND CROWN/BUTTONS

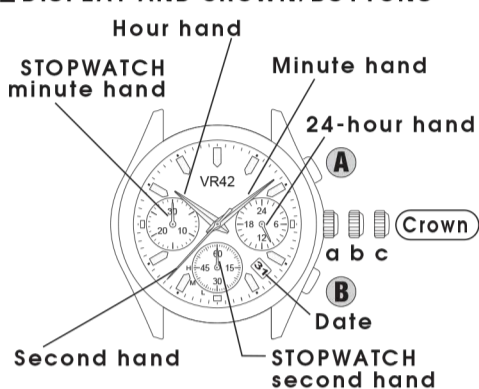

- Normal position
- First click (Date setting)
- Second click (Time setting)

#### 24-hour hand

While the position of the 24-hour sub dial may differ depending on the model, the method of operation is the same.



#### SCREW DOWN CROWN (for models with screw down crown)

#### Unlocking the crown

- Turn Crown counterclockwise until you no longer feel the threads turning.
- Crown can be pulled out.



#### Locking the crown

- Push Crown back in to normal position.
- Turn Crown clockwise while pressing it lightly until tight.



\* When using the watch in water:

Before using the watch in water, be sure the crown is screwed in completely.

Do not operate the crown when the watch is wet or in water.

### ■ SETTING THE TIME AND ADJUSTING THE STOPWATCH HAND POSITION

This watch is designed so that:

- time setting and
- stopwatch hand position adjustment

are both made with the crown at the second click position. Once the crown is pulled out to the second click, be sure to make the above adjustments at the same time.

#### 1) TIME SETTING

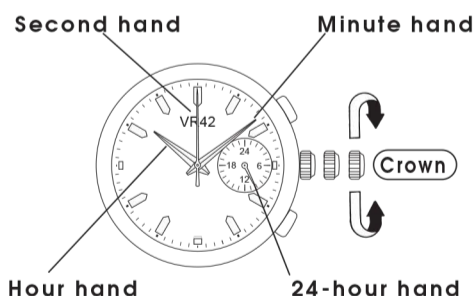

- Pull out the crown to second click when the second hand is at the 12 o'clock position.
- Turn the crown to set the hour and minute hands to the desired time.

- The 24-hour hand moves correspondingly with the hour and minute hands.
- When setting the hour hand, be sure to check that AM/PM is correctly set. The watch is designed so that the date changes once in 24 hours.
- When setting the minute hand, first advance it 4 to 5 minutes ahead of the desired time and then turn it back to the exact minute.
- It is recommended that the hands be set to the time a few minutes ahead of the current time, taking into consideration the time required to adjust the STOPWATCH hand position if necessary.

#### 2) STOPWATCH HAND POSITION ADJUSTMENT

If the STOPWATCH hands are not in the "0" position, follow the procedure below to set them to the "0" position.

#### STOPWATCH minute hand

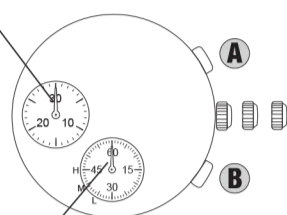

#### STOPWATCH second hand

- Press button A or B repeatedly to set the STOPWATCH hands to the "0'00" position.

- With each pressing of button A, the STOPWATCH second hand advances by one second.
- With each pressing of button B, the STOPWATCH second hand moves back by one second.
- The STOPWATCH minute hand moves correspondingly with the STOPWATCH second hand.
- The hands move quickly if button A or B is kept pressed.

- Push the crown back in to the normal position in accordance with a time signal.

### ■ SETTING THE DATE

Before setting the date, be sure to set the time.

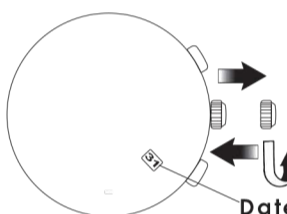

- Pull out the crown to the first click position.
- Turn the crown counterclockwise until the desired date appears.
- Push the crown back to the normal position.

- It is necessary to adjust the date at the end of February and 30-day months.
- Do not set the date between 9:00 p.m. and 1:00 a.m., as the date may not change properly.

### ■ STOPWATCH

- The stopwatch can measure up to 29 minutes and 59 seconds in one second increments.
- When the measurement reaches 30 minutes, the stopwatch automatically stops counting.

#### STOPWATCH minute hand

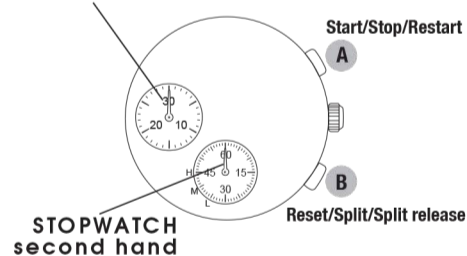

- Before using the stopwatch, be sure to check that the crown is set at the normal position and that the STOPWATCH hands are reset to the "0" position.

#### Standard measurement

A → A → B  
START STOP RESET

#### Split time measurement

A → B → B → A → B  
START SPLIT SPLIT STOP RESET  
RELEASE

#### Measurement of two competitors

A → B → A → B → B  
START FINISH TIME OF 1ST COMPETITOR 2ND COMPETITOR FINISHES FINISH TIME OF 2ND COMPETITOR RESET

- Restart and stop of the stopwatch can be repeated by pressing button A.
- Measurement and release of split time can be repeated by pressing button B.

## ■ HOW TO CHARGE AND START THE WATCH

When you start the watch or when the energy in the rechargeable battery is reduced to an extremely low level, charge it sufficiently by exposing the watch to light.

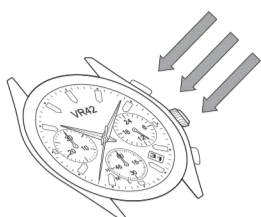

### NOTE

- It is not necessary to charge the watch fully. It is important, however, to charge the watch sufficiently, especially in case of initial charge.

## ■ GUIDELINES FOR CHARGING TIME

Illumination (Lux)	Light source	Environment	Time required (approx.)		
			A (Hours)	B * (Hours)	C (Min.)
700	Fluorescent lamp	Inside office	-	24	108
3,000		30W 20 cm	83	6	27
10,000	Sunlight	Cloudy weather	25	2	8
100,000		Fine weather	3	12 min.	1

The above table provides only general guidelines.

### <Reference>

Condition A: Time required for full charge

Condition B: Time required for steady operation

Condition C: Time required for 1 day's charge

\* The values in this column represent the charging times required until the second hand moves constantly at 1-second intervals after the watch starts operating with the second hand moving at 2-second intervals.

- Even if the watch is not charged for the time specified in the column, the second hand may temporarily move at 1-second intervals. But it will soon resume moving at 2-second intervals, and therefore, charge the watch for more than the specified period.
- When the watch is fully charged, it will continue to operate for about 4 months.

### CAUTION

- When charging the watch, do not place it too close to a hot light source such as a photoflash light, spotlight or incandescent light as this can greatly raise the watch temperature.
- When charging the watch by sunlight, do not leave it exposed to the sun for a long time, on the dashboard of a car, etc., as this can greatly raise the watch temperature.
- Make sure the watch temperature does not exceed 50°C while charging, to avoid damage to the parts inside.

## ■ POWER RESERVE INDICATOR

- The STOPWATCH second hand can be used to check the power reserve amount (continuous operating time).
- Before checking, make sure that the stopwatch is reset (for resetting the stopwatch, see "STOPWATCH").

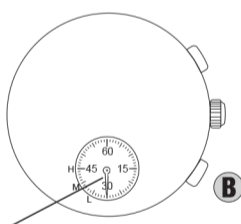

STOPWATCH second hand

Press button B for more than 2 seconds.

The STOPWATCH second hand is set at the 30-second position, and then will move to indicate the power reserve amount for 3 seconds.

QUICK MOVEMENT OF STOPWATCH SECOND HAND *	Low (35 seconds)	Middle (40 seconds)	High (45 seconds)
POWER RESERVE AMOUNT	Less than 30 days	Between 30 and 90 days	More than 90 days

The above table provides only general guidelines.

\* The STOPWATCH second hand will automatically return to the 0 second position after indicating the power reserve amount.

## ■ ENERGY DEPLETION FOREWARNING FUNCTION

- When the energy stored in the rechargeable battery is reduced to an extremely low level, the second hand starts moving at 2-second intervals instead of the normal 1-second intervals.
- In that case, recharge the watch as soon as possible by exposing it to light. Otherwise, the watch may stop operating in about 1 day.
- To prevent the energy depletion
  - When you wear the watch, try not to keep it covered by your clothes.
  - When the watch is not in use, leave it in a bright place as long as possible.

Make sure that the watch temperature does not exceed 50°C.

## ■ NOTES ON POWER SUPPLY

- This watch is provided with a rechargeable battery for exclusive use with the watch. Unlike conventional battery-powered watches, therefore, battery replacement is not necessary.
- The solar cell is a clean energy source, having no adverse effect on the natural environment.

### CAUTION

- Never insert a conventional silver oxide battery in your watch as it may explode, generate an intense heat or catch fire. The watch is designed not to operate even if the battery is installed in it.

## ■ CARE OF YOUR LORUS WATCH

This watch contains precise electronic components. Never attempt to open the case or remove the back cover.

### • WATER RESISTANT

Condition of use	Accidental contact with water, such as splashes and rain	Swimming and taking a shower	Skin diving	Scuba diving
NO INDICATION	NO	NO	NO	NO
WATER RESISTANT	YES	NO	NO	NO
WATER RESISTANT (5 BAR)	YES	YES	NO	NO
WATER RESISTANT (10 BAR OR ABOVE)	YES	YES	YES	NO

\* If your watch is 20 BAR, 10 BAR or 5 BAR water resistant, it is so indicated on the dial/case back.

- Do not operate the buttons when the watch is wet.
- If the watch is exposed to salt water, rinse it in fresh water and then wipe it thoroughly dry.
- Should you find any water or condensation inside the watch, immediately have it checked. Water can corrode electric parts inside the case.

### Caution:

Leather straps are not water resistant except so indicated, even if the watch head is water resistant.

### • ALLERGIC REACTION

Because the case and band touch the skin directly, it is important to clean them regularly. If not, shirt sleeves may be stained and those with delicate skin may develop a rash. Please wear the watch with some play to avoid any possible allergic reaction. If you develop a rash on your wrist, stop wearing and consult a physician.

### • MAGNETISM

Your watch will be adversely affected by strong magnetism. Keep it away from close contact with magnetic objects.

### • SHOCKS AND VIBRATIONS

Your watch may be worn for normal sports activities, but be careful not to drop it or hit it on hard surfaces.

### • TEMPERATURE

Your watch is preadjusted so that constant accuracy may be insured at normal temperature.

### • CLEANING

Use only a soft cloth and clean water for cleaning your watch. Never use chemicals, as the waterproof gasket will corrode.

### ■ SERVICE

When your LORUS watch requires repair or servicing, please see the enclosed WARRANTY/GUARANTEES.