



 **CITIZEN**  
CITIZEN IS A REGISTERED TRADEMARK OF CITIZEN WATCH CO., JAPAN.



---



## §4. SETTING THE TIME AND DATE

If the watch is provided with a cover open, the cover to set the time or date, and then close the cover once the time or date has been set.

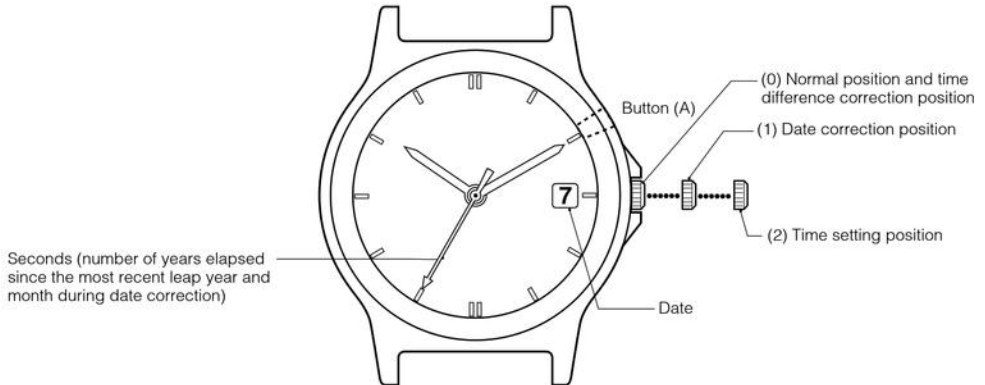

### Setting the Time

1. When the crown is pulled out to the second click (time setting position), the second hand rapidly advances to the 0 seconds position and stops.

**Note:** Align the hands at the reference position after performing the all-reset procedure when the second hand does not stop at the 0 seconds position.

2. Turn the crown and set the time.
  - ① When the crown is turned to the right, the hour and minute hands move forward (clockwise).
  - ② When the crown is turned to the left, the hour and minute hands move backward (counterclockwise).

\* Turning the crown continuously causes the hands to advance rapidly. Turn the crown to either the left or right to stop the hands from advancing rapidly.

**Note 1:** When correcting in the forward direction, the date changes when the hour and minute hands indicate 12:00 AM. However, when the date is changed in the case the hands are advancing rapidly, the hour and minute hands pause at 12:00 AM and then resume advancing rapidly after the date has changed.

**Note 2:** When correcting in the backward direction, the date does not change even if the hour and minute hands pass 12:00 AM.

3. Return the crown to the normal position in synchronization with a telephone time signal or other time service.

## Setting the Date

- This watch is provided with a perpetual calendar function. Once it is set, the year, month and date change automatically, including leap years.



### <How to Read Month and Year>

#### ■ How to read the month:

January: Between 1:00 and 2:00  
 February: Between 2:00 and 3:00

December: Between 12:00 and 1:00

#### ■ How to read the year:

Leap year: First mark in each month zone  
 1 year after most recent leap year: Second mark in each month zone  
 2 years after the most recent leap year: Third mark in each month zone  
 3 years after the most recent leap year: Fourth mark in each month zone

### <Quick Reference Table for No. of Years Since Most Recent Leap Year>

| Year | Years elapsed            | Year | Years elapsed            |
|------|--------------------------|------|--------------------------|
| 2000 | Leap year                | 2004 | Leap year                |
| 2001 | 1st year after leap year | 2005 | 1st year after leap year |
| 2002 | 2nd year after leap year | 2006 | 2nd year after leap year |
| 2003 | 3rd year after leap year | 2007 | 3rd year after leap year |

- When the crown is pulled out to the first click (calendar correction position), the second hand moves to the year and month position stored in memory and stops.
- Turn the crown and set the date.
  - Turn the crown to the right to set the second hand to the position corresponding to the year (number of years elapsed since the most recent leap year) and month. Turning the crown continuously causes the second hand to advance rapidly.

#### Examples:

- \* In the case of December in a leap year: Align the second hand at 0 seconds.
- \* In the case of April, in a year that is three years after the most recent leap year: Align the second hand at 23 seconds (between 4:00 and 5:00).

- The date is advanced by one day if the crown is turned to the left.
  - Turning the crown continuously causes the date to be advanced continuously. Turn the crown to either the left or right to stop the date from advancing continuously.

- Always make sure to return the crown to the normal position after setting the date. The second hand advances to the current seconds and the hands begin to move.





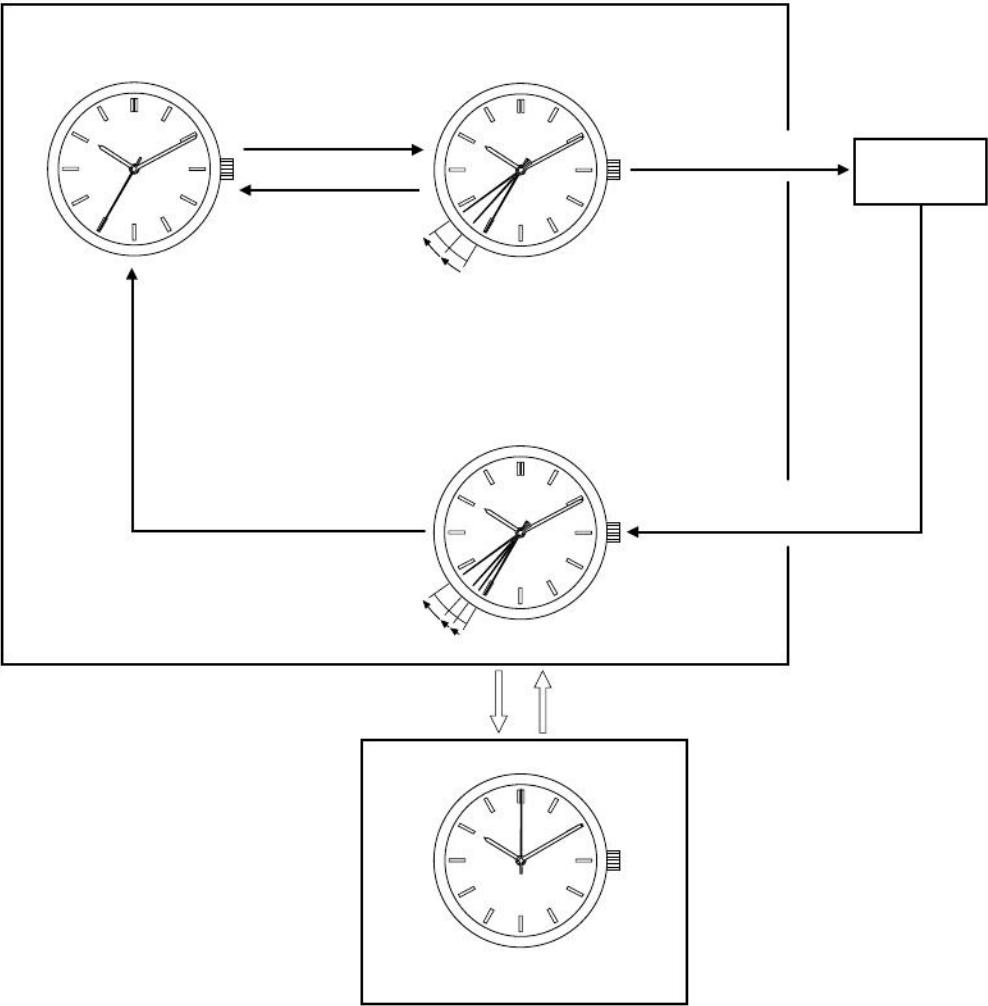

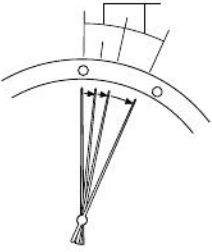
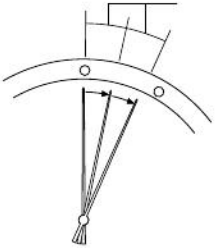



## §9. ALL-RESET

The display of this watch may not read correctly as a result of being subjected to the effects of static electricity or strong impact and so forth. When this happens, perform the procedure described in "10. REFERENCE POSITION ALIGNMENT" after performing the all-reset procedure described below.

1. Pull out the crown to the second click (time setting position).
  - The second hand moves to the 0-position stored in memory and stops.
2. Continuously press button (A) for at least 2 seconds.
  - The hour and minute hands perform a demonstration movement consisting of moving forward then backward and then forward again.
  - The second hand makes one revolution in the forward direction.  
This completes the all-reset procedure. Always make sure to perform the reference position alignment procedure after performing all-reset.

**Note 1:** Demonstration movement is not performed when the watch is insufficiently charged. Perform the all-reset procedure only after charging the watch sufficiently.

**Note 2:** Do not perform the all-reset procedure while the date is changing. This can cause the date position to shift. If the date position should happen to become shifted out of position, pull out the crown to the first click after completing the all-reset procedure, and turn the crown to the left while pressing button (A) to set the date to the correct position.

## §10. REFERENCE POSITION ALIGNMENT

After performing the all-reset procedure, align the hour and minute hands at their reference positions by pulling out the crown to the second click, and the second hand and date to their reference positions by pulling out the crown to the first click.

1. Align the hour and minute hands at the 12:00 position with the crown pulled out to the second click.
  - ① Turning the crown to the right moves the hour and minute hands forward.
  - ② Turning the crown to the left moves the hour and minute hands backward.
  - Turning the crown to the right continuously causes the hour and minute hands to advance rapidly to the right, while turning the crown continuously to the left causes the hour and minute hands to advance rapidly to the left. Turn the crown to the left or right to stop the hands from advancing rapidly.
2. Align the second hand at the 12:00 position with the crown pulled out to the first click. In addition, align the date at "1".
  - ① Turning the crown to the right causes the second hand to move one second forward.
  - ② Turning the crown to the left causes the date to move one day forward.
  - Turning the crown continuously to the left causes the date to advance continuously. Turn the crown to the left or right to stop the date from advancing continuously.
3. Once each hand has been aligned at the 12:00 position and the date has been aligned at "1", return the crown to the 0 position (normal position).

**Note 1:** It takes about 1 second for the watch to store the reference position in memory. Once the reference position has been stored in memory, the second hand will begin irregular two-second interval movement. The reference position may not be stored in memory if the crown is operated before the start of irregular two-second interval movement after returning the crown to the normal position.

**Note 2:** The second hand will continue to remain stopped even if the crown is returned to the normal position unless the reference position alignment procedure is performed.

4. After performing the reference position alignment procedure, properly reset the time and date.
  - The watch shows 12:00 AM after reference position alignment has been performed. Set the time and date by referring to "4. SETTING THE TIME AND DATE" while paying attention to AM and PM.

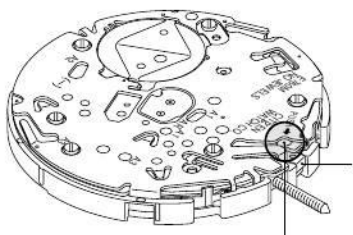
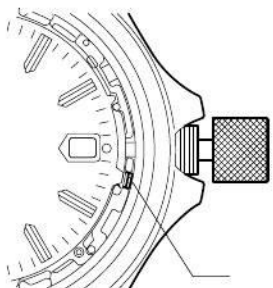

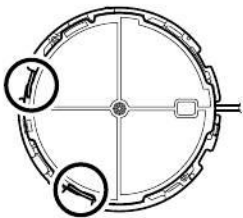
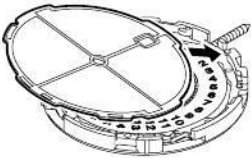
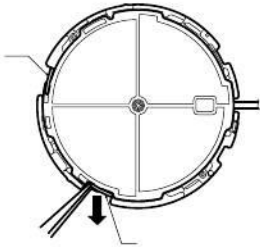

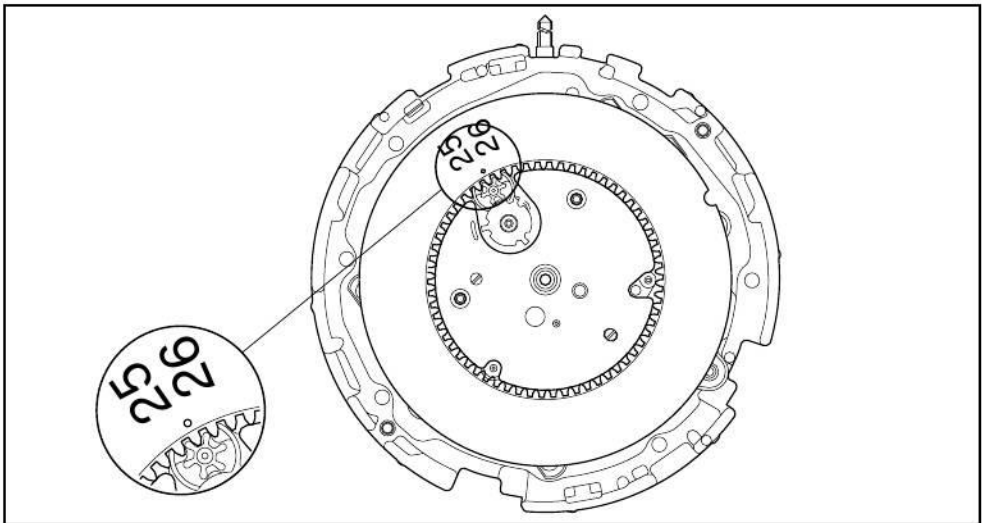
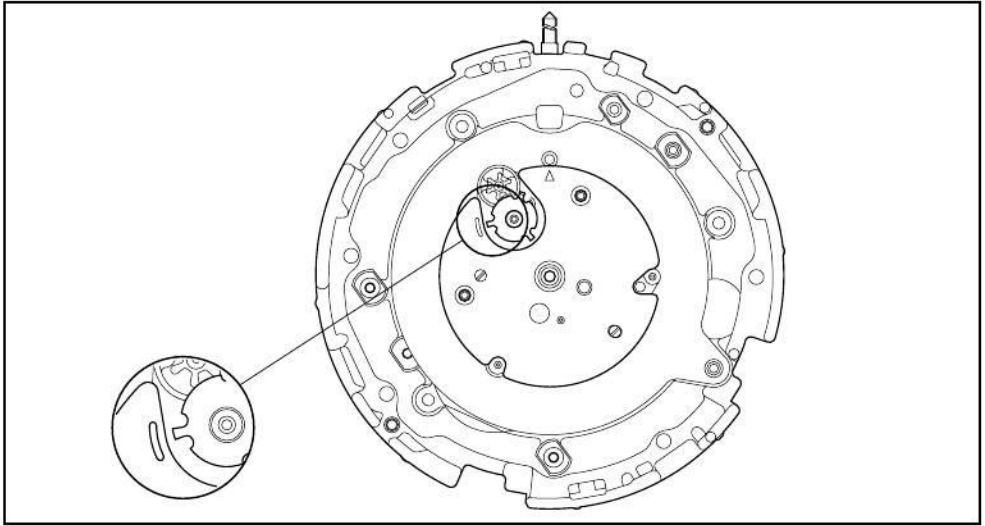

---

## [How to fit hands]

Before fitting the hands, perform the all-reset operation and then start the 1-second interval movement.

1. Perform the "all-reset" operation.
  - ① Pull the crown to the second click and press and hold the (A) button (the switch spring in the 2-o'clock division) for 2 seconds or longer.
2. Perform the "standard position setting".
  - ① Pull the crown to the second click and turn it to the right or left.
  - ② Pull the crown to the first click and turn it to the right or left.
  - ③ Return the crown to the normal position.
  - ④ Pull the crown to the second click and return it to the normal position again, and the watch starts the 1-second interval movement.
3. Fit each hand.
  - Fit the "hour hand" before the 12-o'clock division and pull the crown to the second click and turn it to the right to set the hour hand to the 12-o'clock division.
  - Fit the "minute hand" to the 12-o'clock division.
  - Fit the "second hand" to the 12-o'clock division.
4. Set the movement in the case and perform the "all-reset" operation and "standard position setting" again, then set the time and calendar correctly.

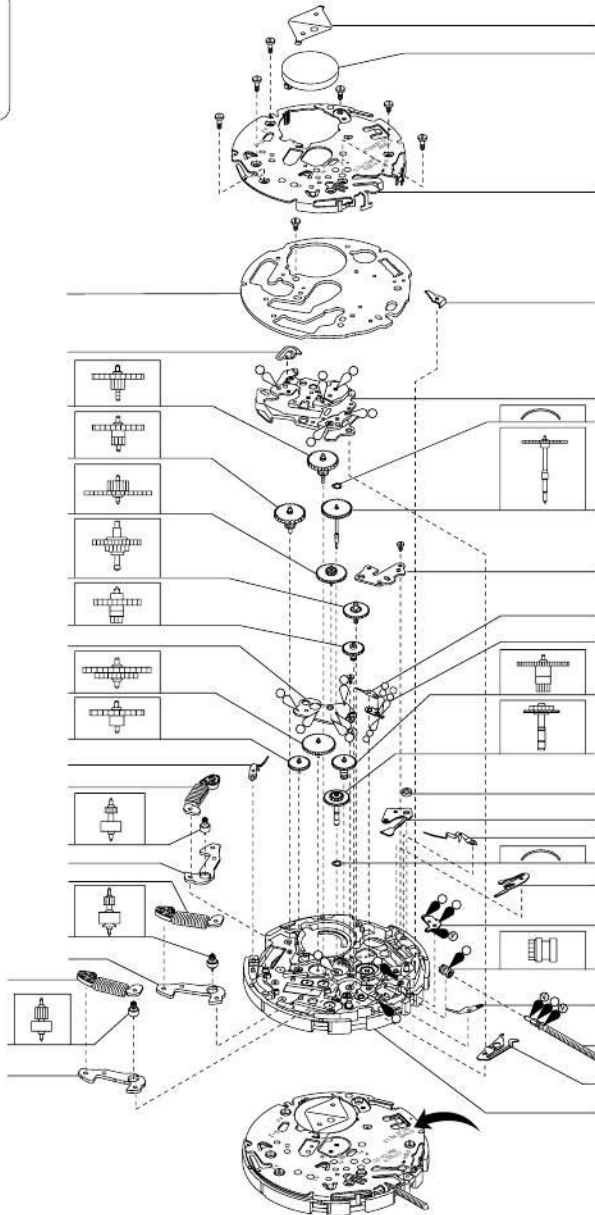
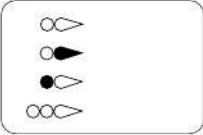

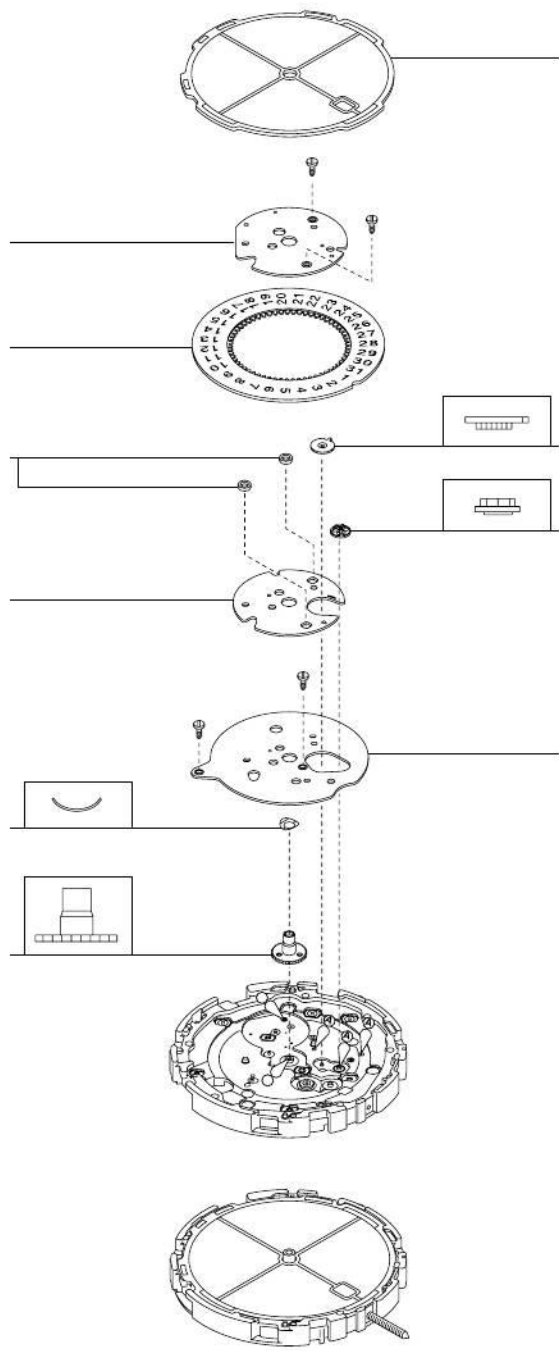



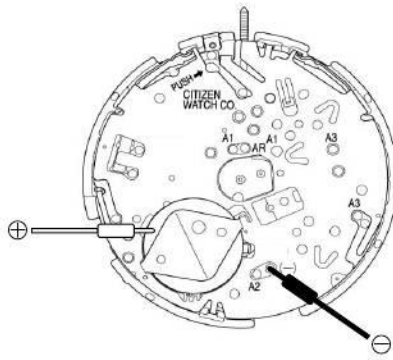

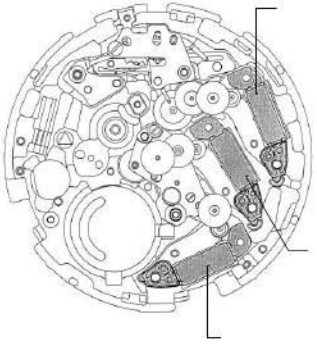

|   |   |  |
|---|---|--|
| <ul style="list-style-type: none"><li>●</li></ul> |  |  |
| <ul style="list-style-type: none"><li>●</li></ul> |   |  |
| <ul style="list-style-type: none"><li>●</li></ul> |   |  |
| <ul style="list-style-type: none"><li>●</li></ul> |   |  |

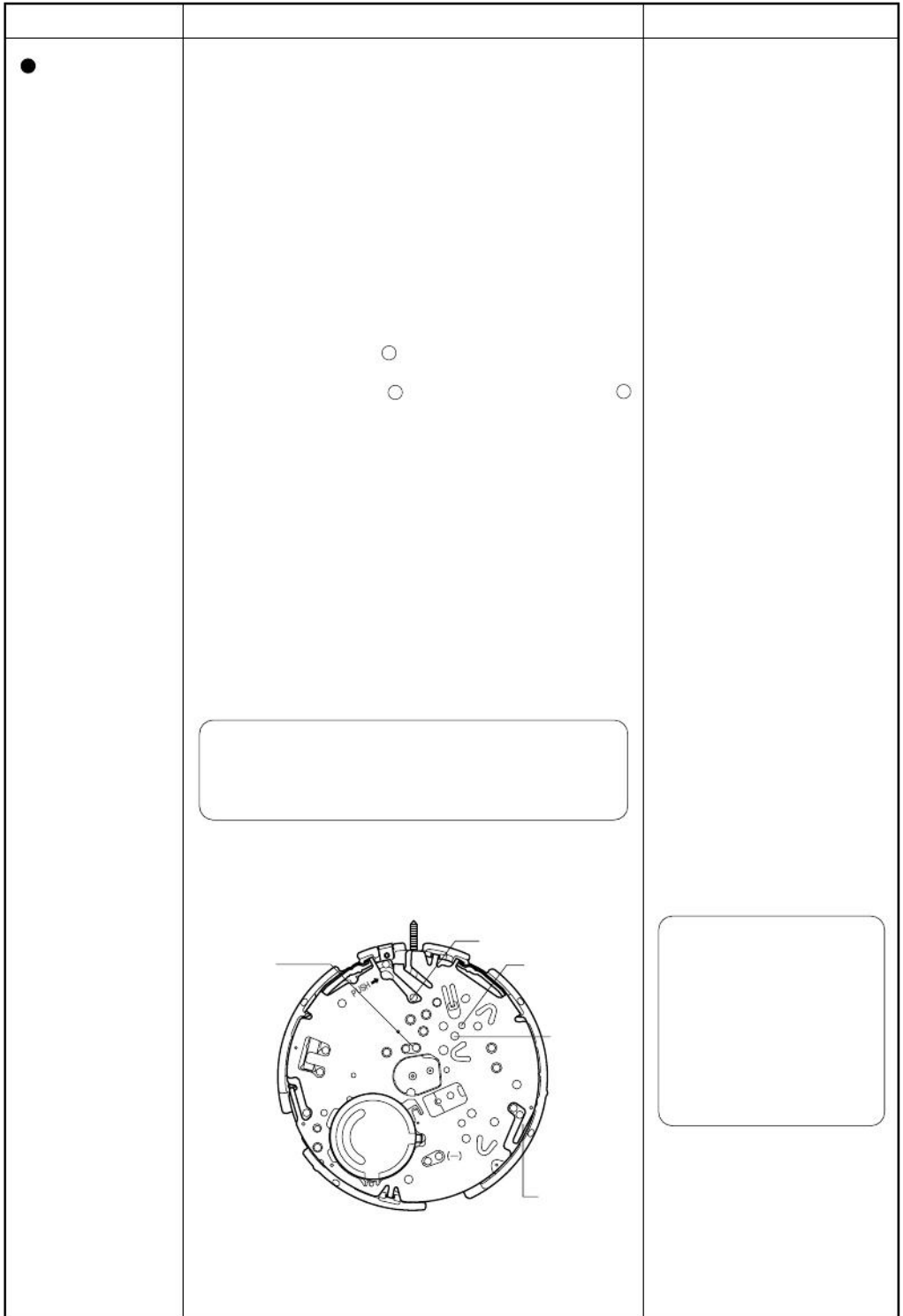

| Check Items                           | How to Check   | Result and Treatment   |
|---------------------------------------|--|--|
| ⑨ Measurement of time                 | <ul style="list-style-type: none"> <li>* Refer to Basic Course: II-2-d.</li> <li>● Since DF measurement is applied, measure in the 10-second range. The time rate cannot be adjusted, however. The time rate may not be measured accurately in the 2-second interval movement or 2-second hitch movement. In this case, apply light to the watch until the second hand moves in the 1-second interval movement, then measure the time rate.</li> </ul>   | <ul style="list-style-type: none"> <li>● Time rate is very different from specification<br/>→ Replace unit of electronic circuit.</li> </ul> |
| ⑩ Confirmation of using condition     | <ul style="list-style-type: none"> <li>* Refer to Basic Course: II-2-e.</li> <li>● Since this watch is energized by light, it should receive light as much as possible. If the watch is placed near a light source which generates heat (above 60°C) such as an incandescent lamp, a halogen lamp, etc., its functions and parts may be deteriorated or deformed by the heat. Accordingly, take care when applying light to it.</li> </ul> <p>Example:<br/>When the watch is hidden under a long sleeve or the customer works in a dark place, it needs to be exposed to light on purpose.</p> |  |
| ⑪ Inspection of outside and functions | <ul style="list-style-type: none"> <li>* Refer to Basic Course: II-2-f.</li> </ul>   |  |
|                                       |  |  |